

WeatherTech®

No-Drill MudFlap

Installation Instructions

Thank you for purchasing the WeatherTech® No-Drill MudFlap. Please read this installation guide to thoroughly familiarize yourself with the steps to install the MudFlap on your vehicle. When properly installed, the WeatherTech® No-Drill MudFlap will provide you with years of protection.

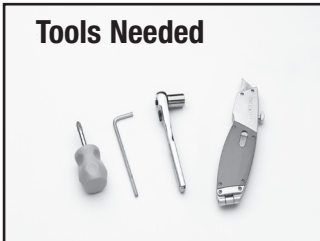

- Phillips screwdriver
- Allen key wrench (included)
- Socket set
- Razor knife

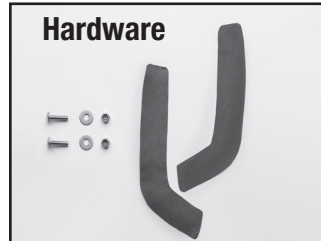

- Parts Kit**
- (2) bolts
 - (2) locking nuts
 - (2) aluminum washers
 - (2) pieces of black film

⚠ WARNING ⚠

The MudFlap is designed to fit vehicles with standard size wheels and tires. Installation of MudFlaps on vehicles with aftermarket wheels or oversize tires may interfere with the MudFlap, will void the warranty and may damage the MudFlap or the vehicle.

1 Start by thoroughly washing your vehicle. Take care to remove all dirt, debris, and stains from each fender in the areas corresponding to where the MudFlaps will be installed.

2 Park the vehicle on level ground with the wheels turned fully to the left. Begin with the driver's side MudFlap installation.

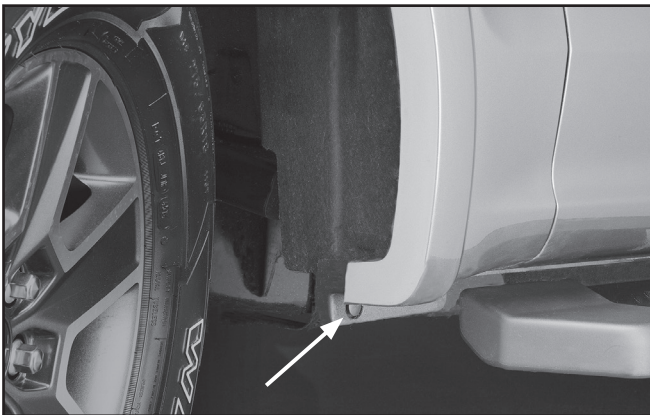

3 Locate the (1) plastic rivet.

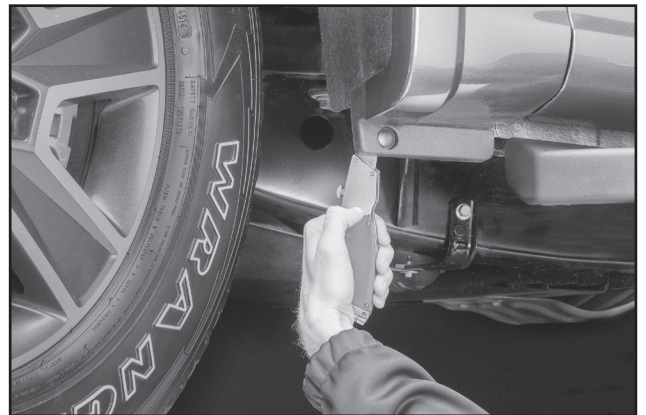

4 Remove the lower plastic rivet by cutting the backside of the rivet head with a razor knife, push rivet head out from behind.

View Easy Installation Video
WeatherTech.com/install



5 Apply the protective film to the wheel well lip.



6 Place the MudFlap marked "LH" up to the wheel well and align with the corresponding hole, ensure the QuickTurn™ fastener is in the unlocked position.

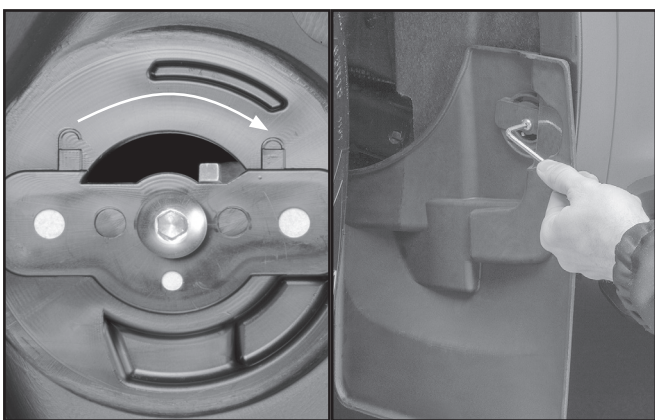

7 While pressing the MudFlap against the fender, rotate the QuickTurn™ fastener with the supplied allen key wrench. The fastener will rotate to the "lock" position and stop. Continue turning to tighten the flap onto the metal fender located behind the plastic flare.



8 Using a bolt, washer and nut; attach the bottom mounting location. Ensure the the washer is placed under the locknut.



9 Install the passenger side MudFlap marked "RH" by turning the wheels fully to the right, repeating steps 3-8.

Congratulations!

Your new WeatherTech® No-Drill MudFlaps have been installed!

Your WeatherTech® No-Drill MudFlap carries a Lifetime Warranty against defects in materials and workmanship when installed correctly.

Questions? Call customer service at (630) 769-1500
Monday - Thursday: 7 a.m. to 11 p.m. Central
Friday: 7 a.m. to 10 p.m. Central
Saturday - Sunday: 8 a.m. to 8 p.m. Central