



# STEEEDA

## Focus ST Front Swaybar

Instructions for 555-1092

**Note:** The installation of this bar should be performed by a technician or under the supervision of a technician. It is a rather difficult installation compared to other swaybars and should take around 2-3 hours. The vehicle will need an alignment following the installation due to the unbolting and lowering of the sub frame assembly.



### Stock Swaybar Removal

1. Lift the car up so that at least the front tires are off the ground a few inches. Be sure not to lift the front of the car by the sub frame, as you will be lowering it in the future. Make sure the car is supported safely.
2. Remove the front tires of the car to make it easier to get access to everything.
3. Remove the nuts from the end links where they connect to the swaybar. The stud will need to be held with a 5mm allen wrench, while the nuts are removed. See figure 1.
4. Remove the belly pan from the subframe.
5. Remove the 2 bolts securing the downpipe support bracket to the sub frame. See figure 2.
6. Make sure the engine and subframe are supported separately. The subframe needs to be supported in way that it can be lowered slightly.
7. Remove the rear sub frame cross brace. There are 4 bolts and 2 nuts securing it. See figure 2.
8. Remove the bolts securing the subframe to the chassis. Figures 2 and 3 show the bolt locations.

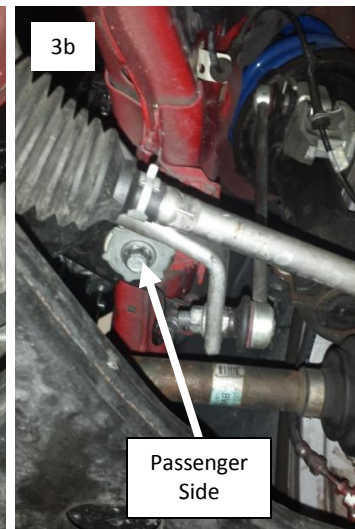
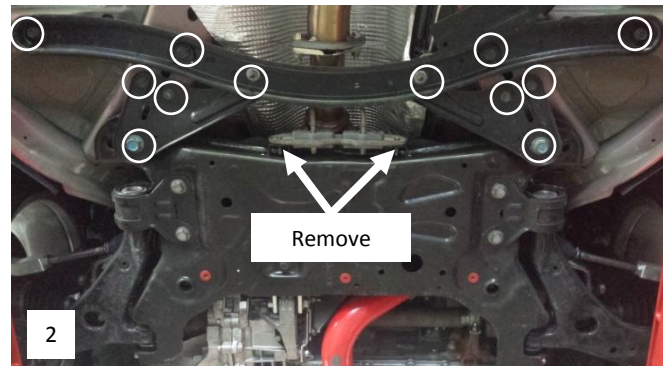

9. Lower the subframe down about 2-3 inches. Remove the 3 bolts securing the steering rack to the subframe. See figure 4a, 4b, & 4c.
10. Remove the 4 nuts and bolts securing the swaybar bushings to the subframe. The bolts go through the rear bushing mount for the lower control arm.
11. Lower the subframe enough to slide the swaybar out towards the back of the car.

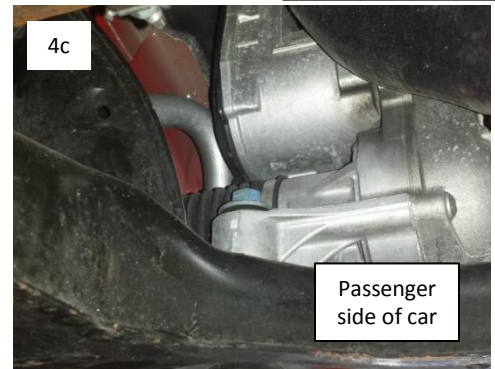
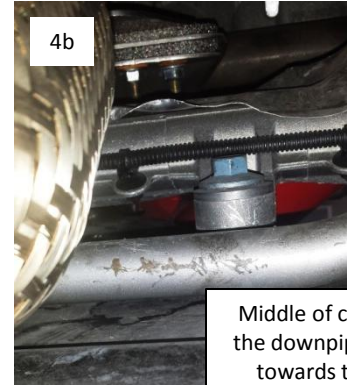
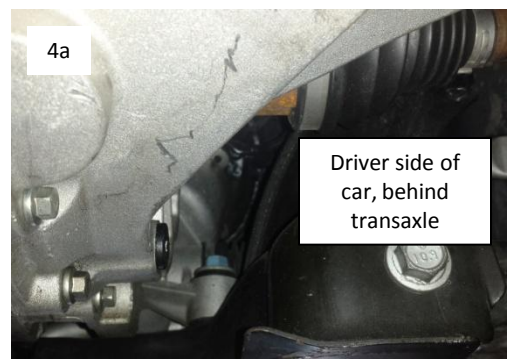

### **Steeda ST Front Swaybar Installation**

1. Apply the provided lubricant onto the inside of the supplied bushings.
2. Install the new bushings onto the new swaybar.
3. Install the new Steeda front swaybar into the car. Use the supplied bushing brackets and OE hardware.
4. Raise the subframe up enough to reinstall and tighten the steering rack to the subframe.
5. Raise the subframe back into its original position and reinstall all OE bolts and nuts.
6. Reinstall the rear subframe support brace.
7. Reinstall the 2 bolts securing the downpipe support bracket to the sub frame.
8. Reinstall the swaybar end links to the Steeda sway bar.

