



INSTALLATION INSTRUCTIONS

DISC BRAKE CONVERSION KITS A120-4 & A120-5

1964-1/2 - 66 Ford & Mercury

Thank you for choosing STAINLESS STEEL BRAKES CORPORATION for your braking needs. Please take the time to read and carefully follow these instructions to insure the ease of your installation as well as the proper performance of the complete system.

Before beginning your installation, please verify you have received all the parts indicated on the packing slip. If you believe anything to be missing or incorrect, please call our Customer Service Department at 716-759-8666.

To assure your installation will go safely and smoothly, have the following items on hand to assist you:

JACK & JACK STANDS
TORQUE WRENCH
TUBE WRENCHES
MALLET
WHEEL BEARING GREASE

LUG WRENCH
SOCKET SET
WRENCH SET
BRAKE FLUID
BRAKE CLEANER

These kits use the following pads:

FMSI#: D-289

Revised to level 3 2/28/12

TIP: BEFORE BEGINNING INSTALLATION, SPRAY ALL FITTINGS AND FASTENERS WITH PENETRATING OIL.

Front Drum Brake Removal

- 1) Raise the car until the wheels and tires clear the floor and support the car on jack stands. Remove the wheel covers or hub caps and remove the wheel and tire assemblies from the drums.
- 2) Remove the grease cap from the hub. Remove the cotter pin, nut lock, adjusting nut, and flat washer from the spindle. Remove the outer bearing. Be sure to save these parts as they will be re-used later.
- 3) Pull the hub and drum assembly from the spindle. If the brake drum will not come off easily, retract shoes by inserting a narrow screwdriver through the brake adjusting slot in the backing plate and disengage the adjusting lever from the adjusting screw. While holding the adjusting lever away from the adjusting screw, back off the adjuster.
- 4) Drain system of all the brake fluid as follows:
 - a) Remove master cylinder cover. Use a syringe to remove as much fluid from the master cylinder reservoir as possible.
 - b) Attach hoses to front bleeder screws and place other end of hose in a container. Open bleeder screw.



BE CAREFUL NOT TO GET BRAKE FLUID ON THE PAINT. IT CAN CAUSE SEVERE DAMAGE!!

- c) When fluid stops draining, disconnect the flexible hoses from the rigid brake line at the frame and remove horseshoe clips. Use plenty of penetrating oil between the tube nut and the mating fitting. We strongly recommend the use of a tube wrench available from any tool supply store including Sears.
- 5) Remove drum brake as follows:
 - a) Remove flexible hose from the back of both brake cylinders and remove brake cylinder.
 - b) Remove entire drum brake assembly as a unit by removing the four (4) bolts attaching the backing plate to the spindle flange. Discard assembly.
- 6) Installation of Caliper Mounting Brackets
 - a) Begin by cleaning the mounting face and bearing surfaces of the spindle. A wire brush can be used on the face of the spindle, but **NOT** on the machined bearing surfaces.
 - b) Install the base bracket on the outward side of the spindle face. The rounded side of the bracket will face towards the front of the car.
 - c) Retain the assembly using the 3/8" bolts and nuts supplied with the kit. Torque to 35-40 ft./lbs.
 - d) Install the main caliper mounting bracket on the back side of the base bracket. Note that the main bracket is cut to follow the shape of the backside of the spindle. When installed correctly the main mounting bracket on the driver's side should position the caliper in the 10 o'clock position. Caliper will be towards the front of the car.
 - e) Secure the two brackets together using the 3/8" - 1" bolts supplied with the kit. Torque the bolts to 35-40 ft./lbs.

- 7) Hubs and Rotors
 - a) Begin by installing the new bearing races into the new hubs included with the kit. Use either a large socket on a brass drift being careful not to nick or damage the races.
 - b) Clean and pack the wheel bearing with a good grade of high-temperature disc brake bearing grease. Install the inner wheel bearings into the races and install the grease seals using a soft mallet or block of wood, so not to distort the seal.
 - c) The hubs can then be slid into place over the spindles. Install the outer wheel bearing, washer, and adjusting nut onto the spindle.
 - d) The wheel bearing adjustment, as follows, is especially important with disc brakes: Rotate the hub while torquing spindle nut to 17-25 ft./lbs. Back off the adjusting nut 1/2 turn and retighten to 10-15 ft./lbs. Selectively position nut retainer on adjusting nut so that a set of slots are in line with the cotter pin hole. Adjusting nut should not be rotated during this operation. Lock adjusting nut and retainer with cotter pin and install grease cap.
 - e) Slide the rotor over the lug studs and onto the hub. Then slide the steel spacer on after the rotor. The side of the spacer with chamfer must go against the rotor face.
 - f) Install one or two lug nuts. Finger tight to keep the assembly in place.
- 8) Caliper Installation
 - a) The calipers come completely assembled including the brake pads.
 - b) Slide the caliper over the rotor and into the cutout of the main mounting bracket. Make sure the bleeder screws are pointing up and tighten the caliper mounting bolts to 35-40 ft./lbs.
 - c) Secure the block end of the flex hose to the caliper using the banjo bolts and copper washers supplied. One copper washer should be placed on either side of the block end of the hose. Torque the banjo bolt to 20 ft./lbs.
 - d) Attach caliper flex line to frame (12-point bracket) push horseshoe slip over end of hose to retain it.
 - e) With both front wheels off the ground, turn wheels through a full left to right turn to insure the hoses do not twist or take a double bend. If hoses do not bend correctly, remove them from the 12-point bracket and re-orient them so that they bend with a minimum of twisting. Failure to complete this part of the installation may cause brake lock-up in service since the thin wall interior hose may collapse and restrict the fluid from relieving caliper line pressure when the brake pedal is released.
- 9) Remove master cylinder, booster and line to distribution block (It is only necessary to remove the booster on 64-1/2 to 66 cars if they are so equipped.)
 - a) Remove and discard brake line from master cylinder to distribution block.
 - b) Remove the fastener that secures the pushrod to the brake pedal and the fasteners that secure the master cylinder or booster/master to the firewall. The unit can then be lifted out of the engine bay as one piece including the pushrod.

10) Master Cylinder and Distribution Block Installation for A120-4, Non-Power Kit only
(A120-5 Skip to Step 11)



THE MASTER CYLINDER MUST BE BENCH BLEED BEFORE INSTALLATION. FOR PROPER BENCH BLEEDING PROCEDURE, SEE THE ATTACHED PAGE.

- a) Pushrod:
- 1) If your car is a 64 $\frac{1}{2}$ -66 and was originally equipped with power drum brakes, you must discard the booster and run the new master cylinder non-power. There is not enough room between the firewall and the shock tower to allow for a power booster and a dual circuit master cylinder. For this reason, power disc brakes were not available from the factory on the 64-1/2 through 66 Mustangs. In this case you will require an adjustable pushrod SSBC part #A21161 which is available at an additional cost.
 - 2) If your car was non-power then you will reuse the pushrod from your old master cylinder. You must first remove the snap ring from the back of the master cylinder and pull the piston and pushrod out of the back of the master cylinder. Once the piston is out, you must then secure it in a vice and, using a hacksaw, cut a slot through the side of the piston parallel to and in line with the pushrod. When you get about half way through the piston, you will cut through the clip and the pushrod will slide out of the piston.
- b) Slide the pushrod into the back of the master cylinder and slide the old rubber dust boot over the pushrod and the back of the master cylinder.



TIP: A DAB OF SILICONE ON THE END OF THE PUSHROD WILL SECURE THE PUSHROD INSIDE THE PISTON.

- c) Slide the master cylinder back onto the firewall and torque the mounting bolts to 6-12 ft-lbs. Reconnect the pushrod to the brake pedal and check to be sure you have 3/4" to 1-1/4" of end play.
- d) Connect the front system prebent line from kit (gold fitting on both ends) between the rear port of the master cylinder and the front port of the distribution block.
- e) Loosely connect the rear system prebent line to the master cylinder. The black fitting goes to the master cylinder and the gold one will go the proportioning valve.

THERE WILL BE ONE UNUSED PORT IN THE DISTRIBUTION BLOCK. THIS PORT MUST BE CAPPED USING THE BRASS PLUG SUPPLIED IN THE KIT.



NOTE: For 64-1/2 cars only an additional adapter fitting will be required to reinstall the pressure switch for the brake lights. Available from SSBC part #A0813.

- 11) Power Booster and Master Cylinder Installation **A120-5 Power Conversion**
- a) Remove the steel brake line going from the master cylinder to the distribution block. Disconnect, but do not remove the steel line going from the distribution block to the rear brakes. Plug that port with the steel plug supplied with the kit.
 - b) From under the dash, disconnect the pushrod from the brake pedal. Remove the master cylinder/booster assembly by removing the mounting bolts and slide the assembly of the firewall.
 - c) Prepare the new booster for assembly by removing the master cylinder and threading the adjustable pushrod onto the back of the booster.
 - d) Slide the new booster into position on the firewall and secure it using the original mounting bolts. **Note:** These bolts will be difficult to tighten. Due to the limited space they must be tightened using a wrench, but by working from top and bottom all the bolts can be tightened. Remember to connect the booster to a direct source of manifold vacuum.
 - e) With the booster secure, connect the new pushrod to the brake pedal using the original hardware. By turning the pushrod, its length can be adjusted to correctly position the pedal height.
 - f) Before installing the master cylinder onto the booster you **MUST** bench bleed the master cylinder per the separate instruction sheet.
 - g) The master cylinder will be slipped over the studs on the booster and secured with the nuts and washers provided.
 - h) The steel line with the two gold fittings and must be bent to connect the rear port of the master cylinder to the open port of the distribution block.
- 12) Proportioning Valve Installation
- a) Position the adjustable proportioning valve between distribution block and fire wall.



APPROXIMATE CORRECT LOCATION OF THIS VALVE IS DETERMINED BY THE REAR SYSTEM PREBENT LINE (FROM KIT). BLACK FITTING FROM THIS LINE IS CONNECTED TO FRONT PORT OF MASTER CYLINDER (NEAREST FRONT BUMPER). GOLD FITTING IS CONNECTED TO PROPORTIONING VALVE.

- b) Install adapter fittings into both ports of proportioning valve.
 - c) Install gold fitting of prebent line (see 10e. above) into "IN" port of proportioning valve.
 - d) Rebend front to rear brake line end and connect to "OUT" port of proportioning valve.
- 13) Filling and Bleeding system
- a) It is advisable to replace the brake fluid if the color is brown or muddy. This is due to water that has been absorbed by the fluid which will eventually corrode the brake lines and master cylinder. This absorbed moisture can also cause a vapor lock situation under extreme braking conditions. Flush system with clean brake fluid and replace with a good grade of disc brake fluid. DOT 3 or DOT 4 fluids are acceptable.
 - b) The simplest and most effective way to bleed your brakes is to use the gravity bleeding approach as follows:
 - 1) With calipers installed, make sure all fittings are tight and master cylinder

- is topped off.
- 2) Open one bleeder screw at a time starting at the wheel farthest from the master cylinder and working your way back around the wheel closest to the master. With bleeder screw open, observe bleeder. At first the fluid will begin to escape with intermittent air bubbles. When the air bubbles stop and a steady flow of fluid is observed for several seconds, close the bleeder valve and move on to the next wheel.



MAKE SURE TO KEEP A CLOSE WATCH OVER THE FLUID LEVEL INSIDE THE MASTER CYLINDER DURING THE BLEEDING PROCESS. NEVER LET THE RESERVOIR RUN DRY. ALWAYS KEEP IT AT LEAST 1/3 FULL.

- 3) After bleeding both wheels and topping of the master cylinder make 20-30 applications of the brake pedal. If a hard pedal is experienced, no further bleeding is required. If pedal is spongy, repeat bleeding process until a hard pedal is achieved.

FINAL INSPECTION

- 14) Once a hard pedal is achieved, all fittings and connections must be inspected to make sure there are not leaks. Also, check the level in both reservoirs of the master cylinder and top off, if needed.
- 15) Put wheels back on the car and turn wheel by hand to insure that the wheel spins freely and does not interfere with any brake components. If any interferences are detected, **DO NOT** drive vehicle until problem can be identified and corrected.

DO NOT DRIVE IN TRAFFIC UNTIL THE BRAKES SAFELY STOP THE CAR A SAFE DISTANCE WITHOUT A SPONGY PEDAL FEEL!

BRAKING TESTS SHOULD ALWAYS BE DONE IN A SAFE OPEN AREA!

NOTE: For frequently asked questions and technical reference information please visit the tech section of our website at www.ssbrakes.com.

TECH LINE -- If technical help is required, please call 716-759-8666.

NOW ENJOY TRUE PERFORMANCE BRAKING!

Booster / master cylinder for kit A120-5.

A28143

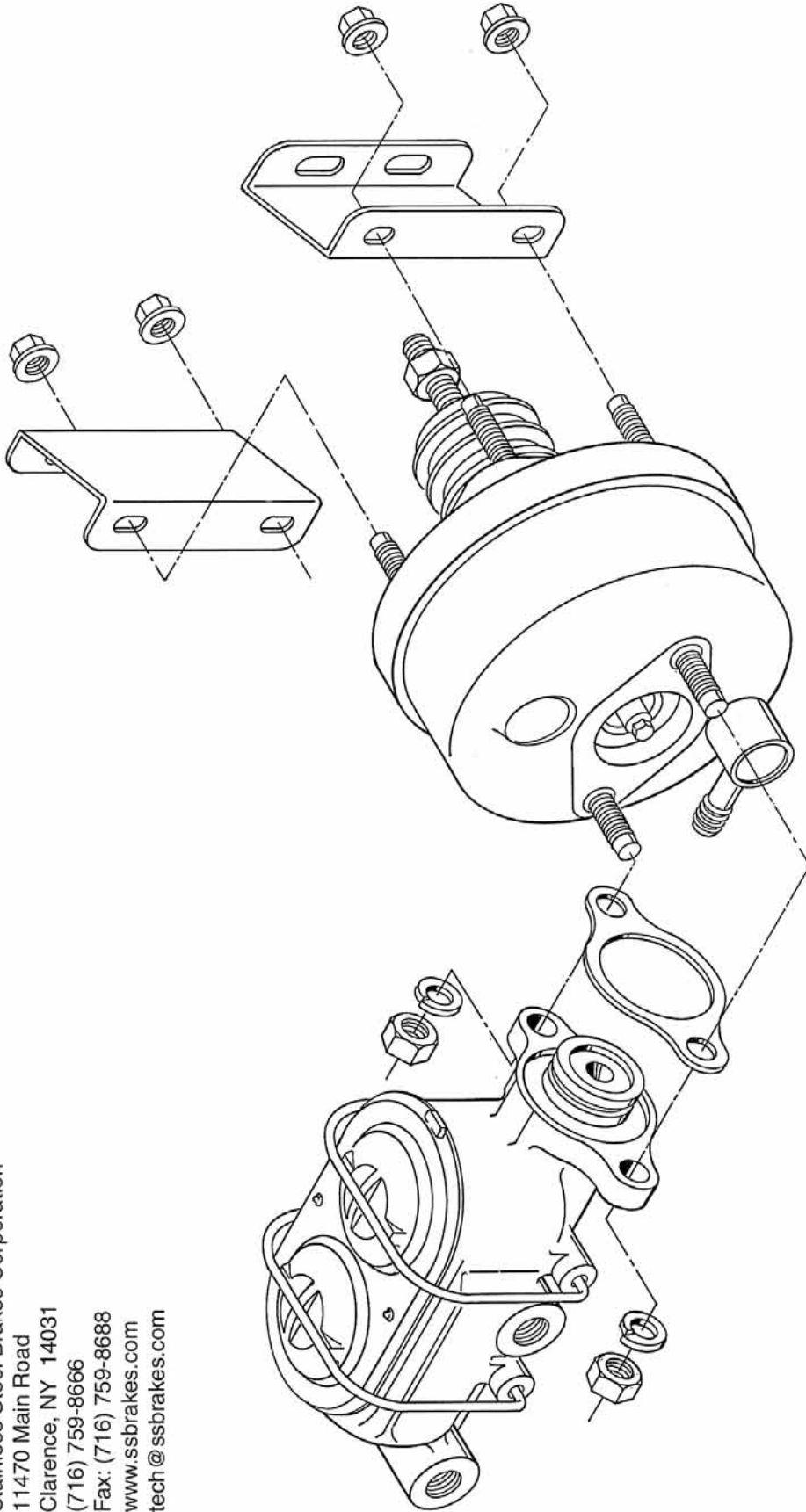

 Stainless Steel Brakes Corporation
11470 Main Road
Clarence, NY 14031
(716) 759-8666
Fax: (716) 759-8688
www.ssbrakes.com
tech@ssbrakes.com

Typical Brake Line Plumbing Diagram for vehicles with 5 port distribution block

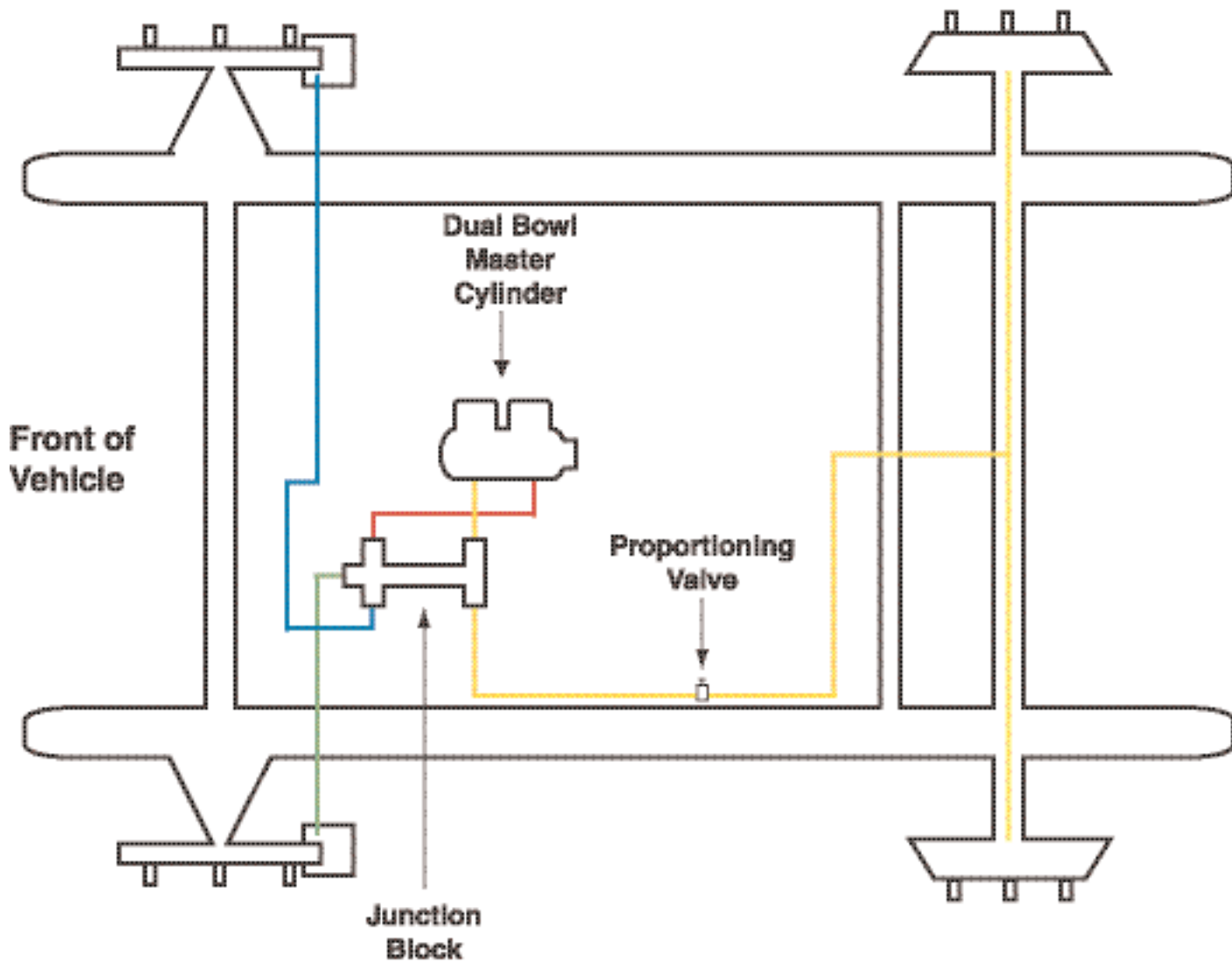

Rear bowl of master cylinder goes to junction block, which then feeds the front brakes.

Front bowl of master cylinder goes to junction block, then goes through proportioning valve, which then feeds the rear brakes.

Typical Brake Line Plumbing Diagram for vehicles without 5 port distribution block

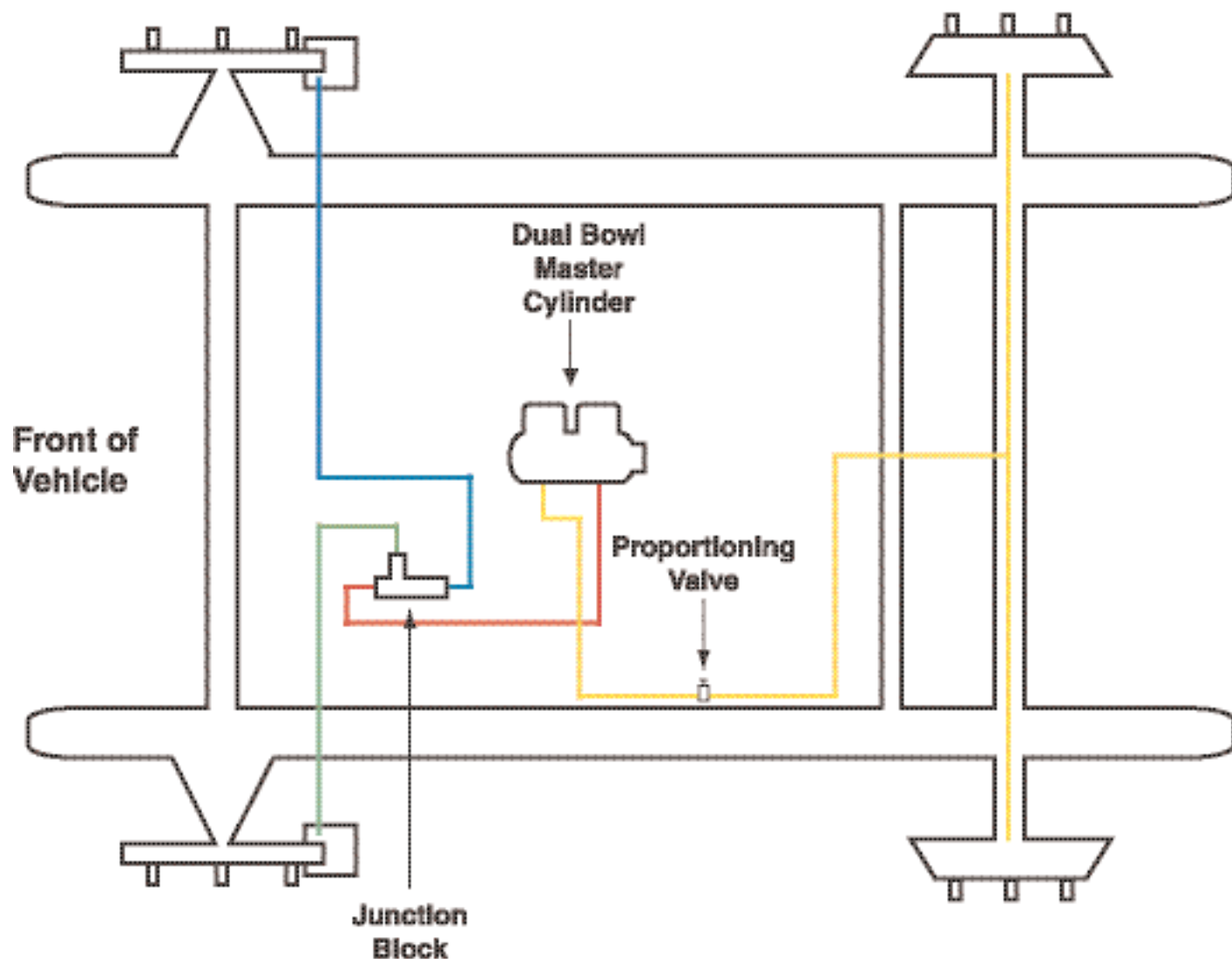

Back bowl of master cylinder goes to junction block, which then feeds the front brakes.

Front bowl of master cylinder goes to proportioning valve, which then feeds the rear brakes.

How and why do I bench bleed a master cylinder?

When installing or replacing a master cylinder, it is critical that all air is removed from the master cylinder. This can easily be done by bench bleeding the master cylinder prior to installation. Using the SSBC master cylinder bleeder kit (#0460):

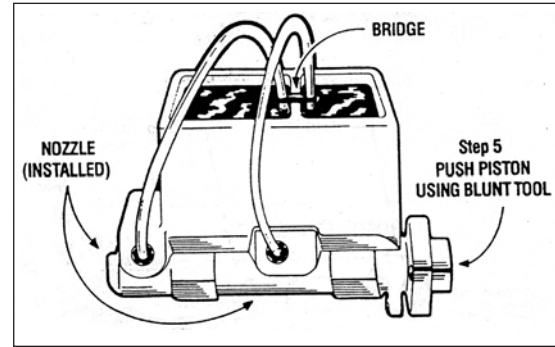

- 1) Place your master cylinder in a vise by the ears (not body). Make sure it is level.
- 2) Attach a piece of clear plastic hose to the short end of one of the plastic nozzles. Do the same to the other hose and nozzle.
- 3) Clip the plastic bridge to the wall and push the ends of the hose through the holes so they are SUBMERGED in the reservoir on either side of the wall.
- 4) Press the tapered end of the nozzle FIRMLY into the cylinder port hole with a twisting motion. Repeat this procedure on the other port hole.
- 5) Fill the reservoir with CLEAN brake fluid recommended by the manufacturer.
- 6) Using full strokes, push the piston in, then release. Do this until ALL the air bubbles have disappeared from the clear plastic hose. **(CAUTION-MASTER CYLINDER WILL NOT BLEED PROPERLY UNLESS HOSES ARE SUBMERGED IN BRAKE FLUID UNTIL THE BLEEDING PROCESS IS COMPLETED.)**

Now mount master cylinder and avoid brake fluid leaking out of front and rear ports during installation.

Bleeding steps for Dual Port Master Cylinder

If you have a master cylinder with dual port holes (4 port holes - 2 on each side), it is necessary to bleed both port sides of the master cylinder. If both sides of the master cylinder are not bled, there will be air trapped in the master cylinder and your brakes will not function properly.

To bleed dual port master cylinders:

- 1) Follow steps 1 - 6 above on the side you will be hooking the brake lines to. Plug the other side.
- 2) Once the air bubbles are no longer visible in the plastic hose, open the bleeder screws in the supplied plugs and allow the mater cylinder to gravity bleed. **DO NOT** push the master cylinder piston in while the plugs are gravity bleeding.
- 3) When clear, steady streams of fluid are coming out of both bleeders, close and tighten the bleeders. Give the master cylinder piston several strokes, making sure there are still no bubbles present in the clear plastic tubes.
- 4) Remove the tubes and plastic fittings and mount the master cylinder on the vehicle being careful not to spill brake fluid on any painted surfaces.

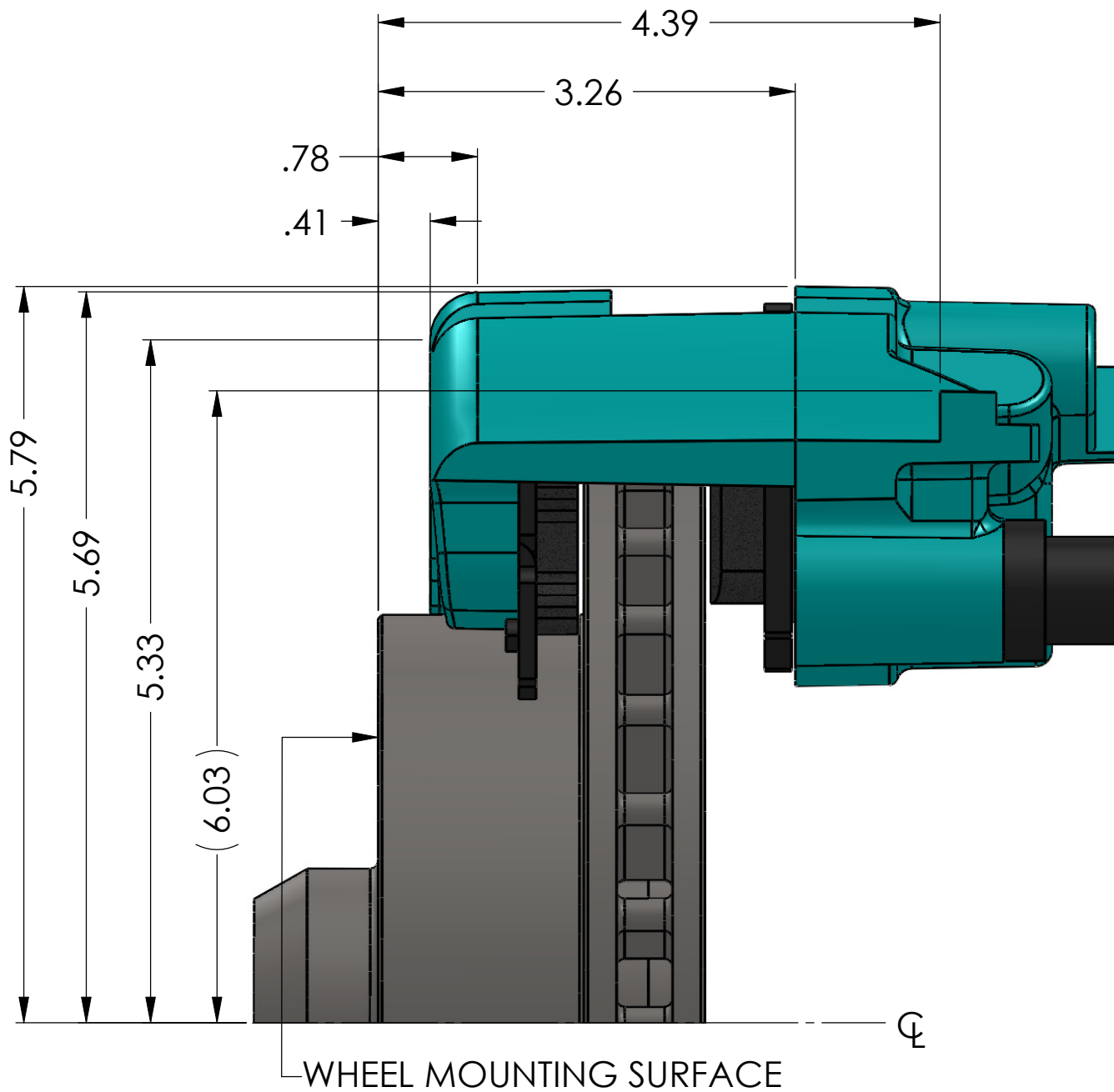

DIMENSIONS ARE IN INCHES

TEMPLATE NO.
T-021

DO NOT SCALE
DRAWING

REV
-

SSBC

STAINLESS STEEL BRAKE CORP.

CLARENCE, NEW YORK 14031-1720
Ph: 716-759-8666 / 800-448-7722 ~ Fx: 716-759-8688
WWW.SSBRAKES.COM