



**Master Power Brakes  
Disc brake Conversion Kit  
Various Ford Applications  
P/N: DB1521BNS & DB1521BNSHP**



**Installation Notes:**

- Please read all instructions before attempting the installation.
- Proper operation of your brakes is essential for your safety and the safety of others. Any brake service should be performed by a professional technician experienced in the installation of brake systems.
- Any installation requiring you to remove a wheel or gain access under the vehicle requires use of jack stands or a lift appropriate to the weight of the vehicle. In all cases, recommended ratings for jack stands should be at least 2-tons. If using a floor jack, be sure to use the appropriate wheel chocks.
- All installations require proper safety procedures and protective eyewear.
- A selection of hand tools sufficient to engage in the installation of these products is assumed and is the responsibility of the installer to have in his/her possession prior to beginning this installation. All installations, which require removal of hydraulic hoses and/or bleeding of the brakes, require appropriate fitting/line wrenches, as well as a safety catch can and protective eyewear. Other than these items, if unique or special tools are required they are listed in the section for that step.
- **ALWAYS CONFIRM WHEEL FITMENT PRIOR TO BEGINNING THE INSTALLATION OF ANY BRAKE SYSTEM!!** Returns will not be accepted for ANY installed part or assembly. Use great care to prevent cosmetic damage when performing wheel fit check!
- Before starting the installation, verify that all parts are included with the brake kit. If items are missing, notify Master Power Brakes immediately.
- Master Power Brakes recommends the use of a high quality DOT 3 or DOT 4 brake fluid. **ALL WARRANTY IS VOID IF DOT 5 FLUID IS USED.**

If you have any questions regarding installation, feel free to contact Master Power Brakes at (888) 351-8781 or through our website at [www.mpbrakes.com](http://www.mpbrakes.com).

Parts List	
Quantity	Description
1	Driver Side Caliper (Includes brake pads)
1	Passenger Side Caliper (Includes brake pads)
2	Rotors
1	Driver Side Caliper Mounting Bracket
1	Passenger Side Caliper Mounting Bracket
1	Driver Side Brake Rotor Backing Plate
1	Passenger Side Brake Rotor Backing Plate
2	A2 Outer Wheel Bearing
2	A6 Inner Wheel Bearing
2	A12 Outer Wheel Bearing
2	A13 Inner Wheel Bearing
2	6815 Inner Grease Seal
2	Brake Hose Kit (Includes: hoses, bolts, washers)
6	3/8"-24 x 1 1/2" Grade 8 Hex Head Bolt
2	3/8"-24 x 2 1/2" Grade 8 Hex Head Bolt
8	3/8"-24 Nyloc Nut
4	7/16" Grade 8 Lock Washer
1	Spindle Nut Kit (Small)
1	Spindle Nut Kit (Large)
2	Rotor Grease Cap

Replacement Parts	
Front Brake Pads	FMSI No: D11

## Installation:

1. With the vehicle properly supported, remove the front wheels and tires.
2. Removing of the factory drum brake assembly is required next. Remove the drum and hub assembly along with the shoes, hardware and backing plate along with the brake hoses.
3. Before installing the disc brake kit, inspect the spindles for any excessive wear or damage. If any is present, replace, replace the spindle(s) as necessary. If spindles are good clean all attachment points along with the spindle pin to insure proper installation of the new components.
4. Included in the kit are two different bearing sets. Measurements must be taken of your original spindles to determine proper usage. To do this, measure the base of the spindle pin where the inner bearing rides. If the pin diameter measures 1.250", then you will use the A2 outer bearing and the A6 inner bearing. If the pin diameter measures 1.375", then you will use the A12 outer bearing and the A13 inner bearing. If the A12 and the A13 bearings are required, it is necessary to change the bearing race in the rotors. Simply remove the races from the rotor and install the new ones provided with the bearings.
5. Before installing the wheel bearings into the rotors, it is recommended that the rotors be thoroughly cleaned with soap and water. Be sure to dry them after cleaning.

6. The wheel bearings can now be packed with a high quality wheel bearing grease available at your local parts store and the bearings can be installed in the rotors at this time. Once the inner bearing is installed, tap the inner seal in at this point. Figures 1 and 2 show the bearing and seal being installed.

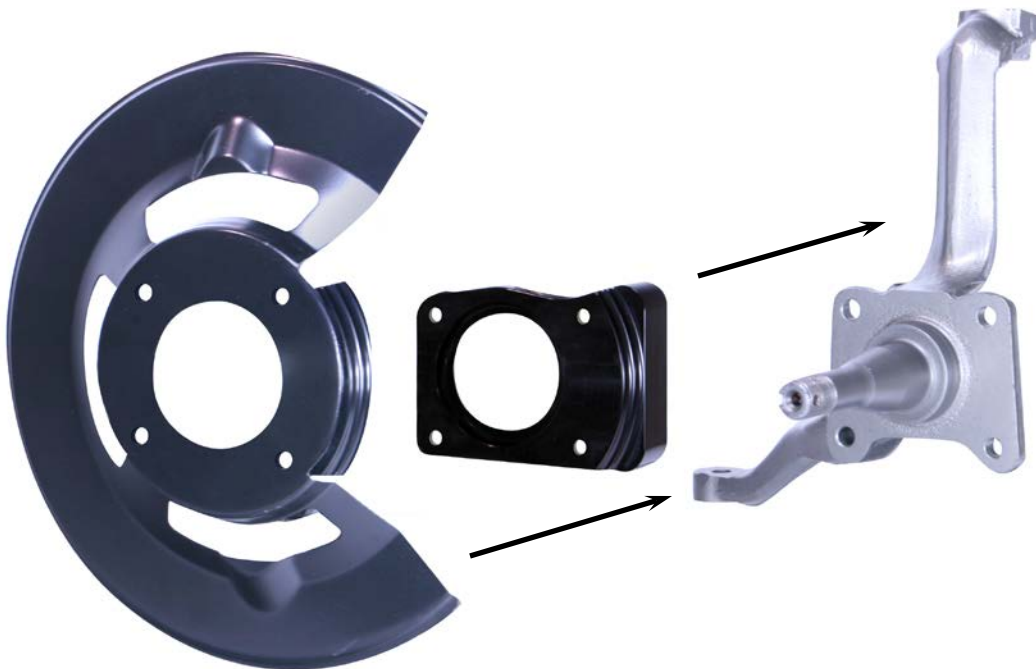

**Figure 1 – Inner Wheel Bearing Installation**



**Figure 2 – Inner Wheel Seal Installation**

7. Install the caliper bracket along with the backing plate onto the spindle. To install, use the provided (3) 3/8"-24 x 1 1/2" Grade 8 bolts and (1) 3/8"-24 X 2 1/2" Grade 8 bolt along with (4) 3/8"-24 Nyloc lock nuts. The longer of the bolts installs in the bottom hole closest to the steer arm. The caliper mounting bracket installs against the spindle with the backing plate installing next. See Figure 3 below for reference. Torque the bolts to 45 ft/lbs.



**Figure 3 – Sequence of Installing the Caliper Mounting Bracket and Backing Plate to the Spindle**

8. Slide the rotor onto the spindle. The inner wheel bearing and grease seal should be installed at this point. With the rotor fully pushed onto the spindle, install the outer wheel bearing followed by the keyed washer and the spindle nut. When tightening the spindle nut, tighten to 5-10 ft/lbs. Loosen the nut and tighten again using the same 5-10 ft/lbs. Do this a couple of times spinning the rotor to fully seat the wheel bearings onto the spindle. Loosen the nut a final time and re-tighten to move all play. Tighten approximately an additional 1/16<sup>th</sup> of a turn to give the appropriate pre-load and line up the cotter pin hole. Install the spindle nut retainer and the cotter pin to secure followed by the grease cap.
9. Mount the caliper to the caliper mounting bracket. With the pads installed in the caliper, slide the caliper over the rotor and line up the mounting ears of the caliper with the holes in the caliper mounting bracket. Using the provided 7/16"-14 x 1 1/2" Grade 8 Hex Head Bolts and 7/16" Lock washers, tighten and torque the bolts to 80 ft/lbs. **NOTE:** When installing the calipers, make sure the brake bleeders are pointing upward. See Figure 4 below for reference.

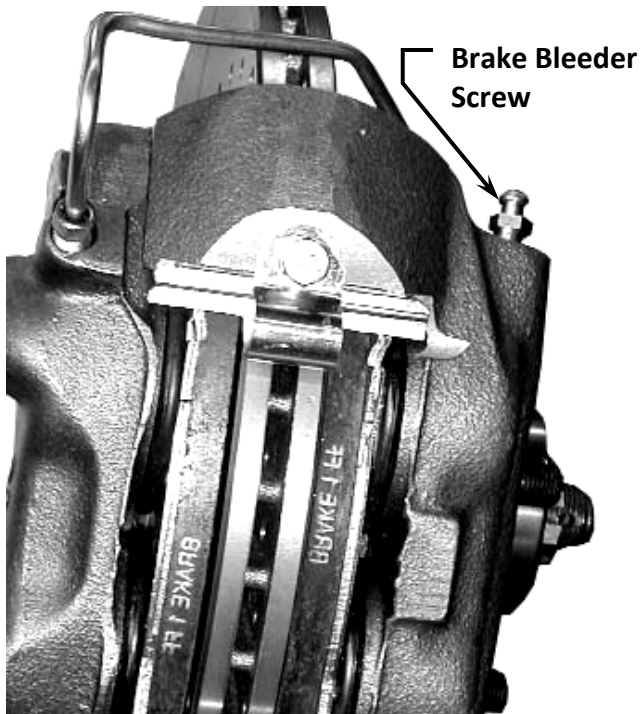

Figure 4 – Brake Bleeder Screw

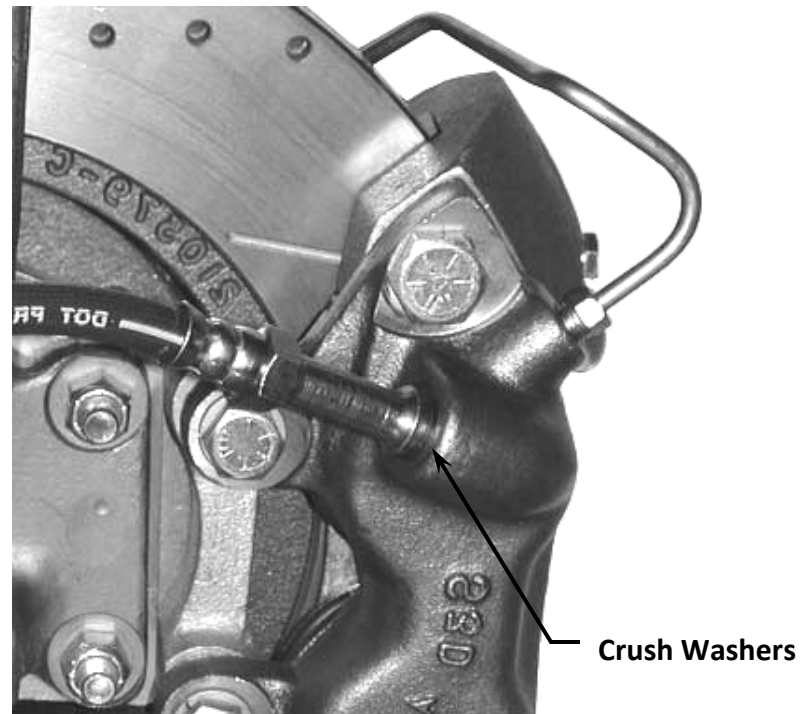

Figure 5 – Brake Hose Installed

10. Install the brake hoses onto the caliper and attach to the original plumbing on the vehicle. **NOTE:** Be sure the copper crush washer has been installed on the brake hose to prevent leaks before installing. Figure 5 above shows the installed brake hose at the caliper.
11. Once the master cylinder has been properly bench bled and then installed on the vehicle, the remaining brake system can be bled to remove all of the air from the system.
12. The installation is complete.

If you have any questions or comments, please call Master Power Brakes at (888) 351-8781.