

BBK PERFORMANCE LLC  
3060 Performance Circle  
Deland, FL 32724

For any questions, email us:  
TECH@BBKPERFORMANCE.COM



## INSTALLATION INSTRUCTIONS - INS187

# CAT-BACK SYSTEM

Part # 3001 / 1986 - 2004 Mustang, All V8

**DOES NOT FIT 2003-2004 COBRA OR 1987-1993 GT**

Part # 3002 / 1987 - 1993 Mustang GT.



**Special Tools required:** Sawz-All.



**Install Time:** Approximately 1 hour and 30 minutes.



**Difficulty:** Average.

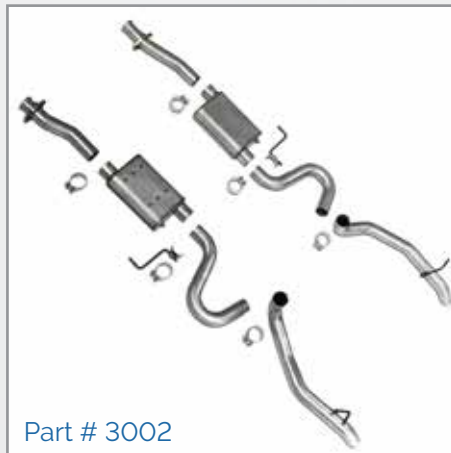

Part # 3002

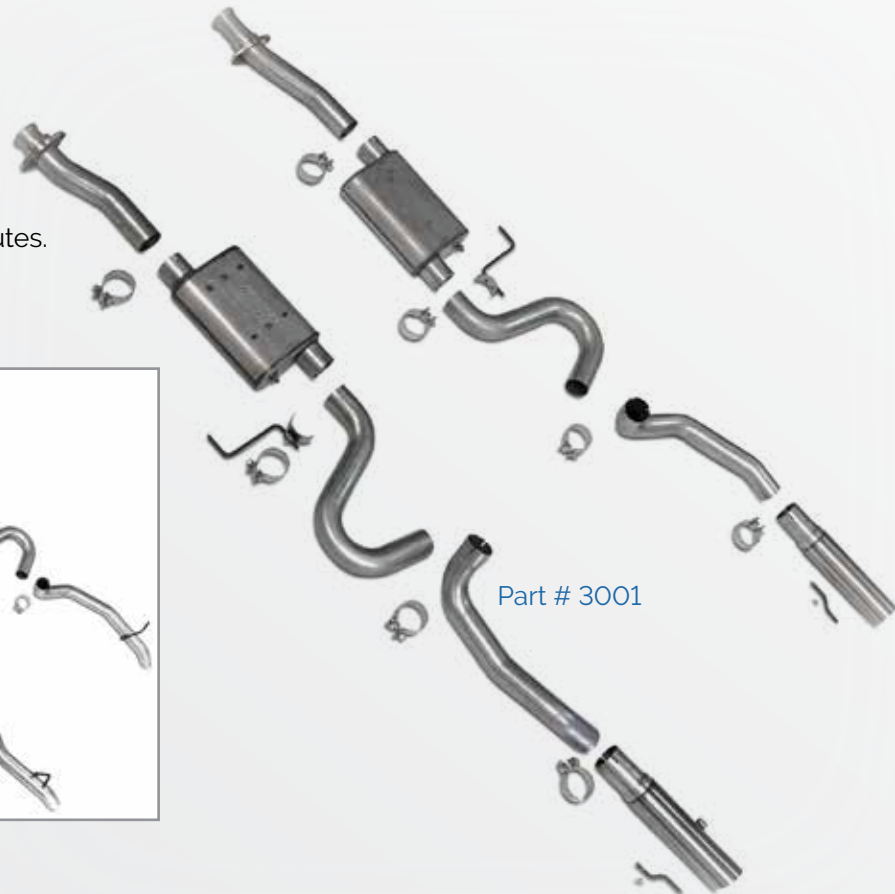

Part # 3001

MADE IN U.S.A.

IMPORTANT: All appropriate safety equipment and gear must be used during the installation of this or any BBK Performance products or any time you work on a vehicle. BBK Performance accepts no responsibility for injuries or damage caused by or during the installation of this product.

UPDATED LAST: March 2019

FOLLOW THESE INSTRUCTIONS CAREFULLY TO ENSURE CORRECT FITMENT AND OPERATION

STEP 1

Lift the vehicle and support using jack stands.

STEP 2

To aid in removal of the stock exhaust system a sawz-all is required.

STEP 3

Remove the bolts connecting the exhaust pipes and cut somewhere between the axle and the back of the muffler.

STEP 4

View the picture on page 3 to see how all the tubing will be fitted and lined up for installation.

STEP 5

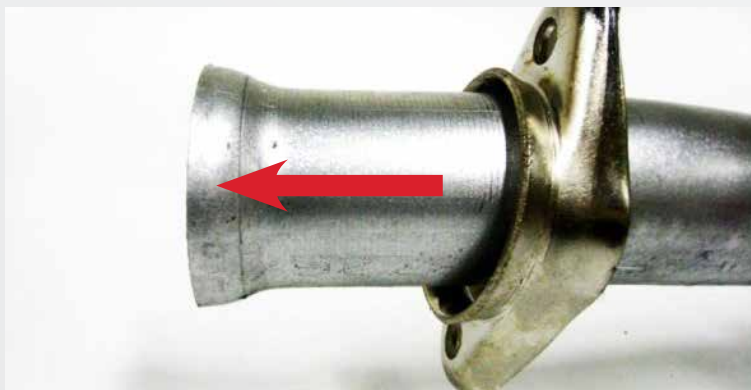

Slide the flared flanges over the head pipes so that the flared end of the flanges match the flared end of the head pipes as shown.

STEP 6

Place the head pipes into the correct location and snug the bolts enough for some adjusting room. Slide the 2 3/4" clamp over the muffler inlet and slide the muffler over the head pipe then snug the clamp down.

STEP 7

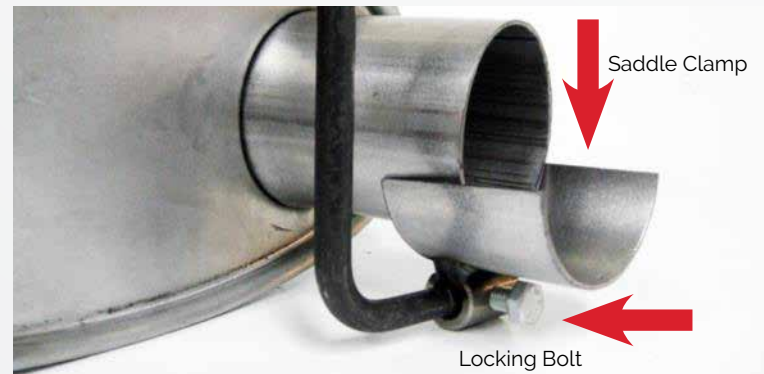

Use the hanger and saddle clamp for the outlet of the muffler. Slide the hanger through the corresponding rubber grommet on the chassis then snug the hanger into the saddle clamp and tighten the locking bolt to hold the hanger in place.

STEP 8

Slide the over axle tube into the muffler then snug the saddle clamp. Slide the 2 3/4" clamp at the end of the over axle tube.

STEP 9

Slide the hanger on the exit tube into the correct rubber grommet, then slide the tube over the over axle pipe. Snug the clamp.

**NOTE: THE 87-93 GT HAS WELDED HANGERS ON THE EXIT PIPES.**

 **MADE IN U.S.A.** 

IMPORTANT: All appropriate safety equipment and gear must be used during the installation of this or any BBK Performance products or any time you work on a vehicle. BBK Performance accepts no responsibility for injuries or damage caused by or during the installation of this product.

UPDATED LAST: March 2019

FOLLOW THESE INSTRUCTIONS CAREFULLY TO ENSURE CORRECT FITMENT AND OPERATION

### STEP 10

For passenger side installation repeat steps 4-8.

### STEP 11

Make final adjustments and tighten the axle back system starting from the front.

### FITMENT FOR INSTALLATION

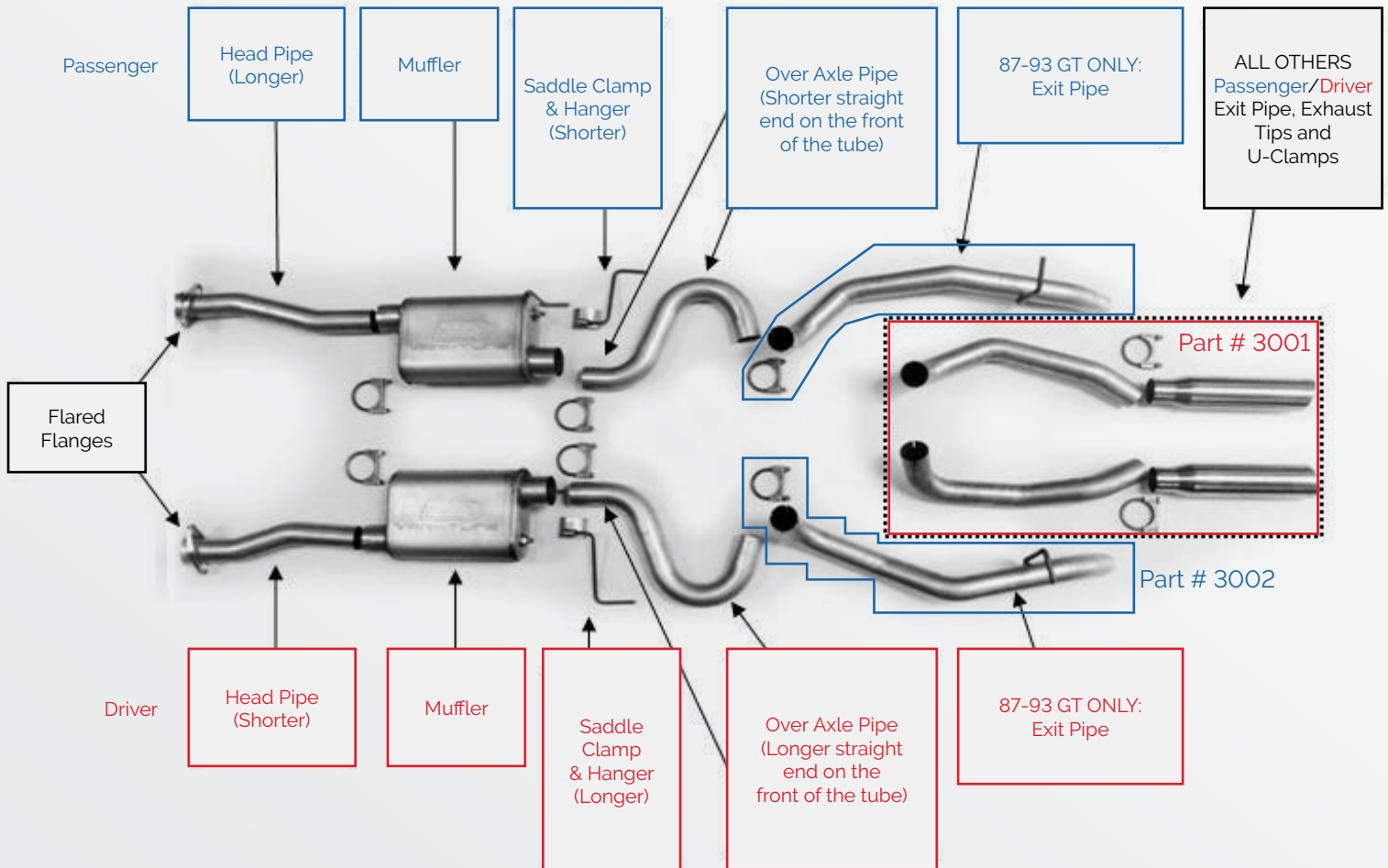

MADE IN U.S.A.

IMPORTANT: All appropriate safety equipment and gear must be used during the installation of this or any BBK Performance products or any time you work on a vehicle. BBK Performance accepts no responsibility for injuries or damage caused by or during the installation of this product.

UPDATED LAST: March 2019