

2018+ Mustang GT 5.0L

CORSA
PERFORMANCE

Part #: CC0003



IMPORTANT! WARRANTY AND INSTALLATION INSTRUCTIONS

Please Forward All Information to Consumer

Be sure to review the enclosed instructions prior to beginning the installation process. If you have any questions about the enclosed parts or instructions, or if you encounter a problem during installation:

CALL TECHNICAL SUPPORT: 440.891.0999 or 800.486.0999

**TO ACTIVATE YOUR WARRANTY GO TO:
CORSAPERFORMANCE.COM/WARRANTY**

COLOR INSTRUCTIONS ARE AVAILABLE BY PART NUMBER ON: CORSAPERFORMANCE.COM



NEVER work on a hot engine bay.
Allow time for the vehicle to cool.

INSTALL DIFFICULTY



RECOMMENDED TOOLS & SUPPLIES

- 10mm Wrench
- 8mm Wrench
- Flathead Screwdriver
- 11/16" Wrench
- 2.5mm Hex Wrench
-
-

2018+ Mustang GT 5.0L

CATCH CAN

Part #: CC0003



Please take time to read and understand these installation instructions.

CORSA recommends that the installation of this system be performed by a qualified service center or professional installer who has the necessary equipment, tools, and experienced personnel. However, if you decide to perform this installation yourself, the use of an additional person may be required.

WARNING: Never work on a hot engine bay. Allow time for the vehicle to cool.

This warranty does not extend to damaged or defect in the finish of a product or to any product, that in the opinion of CORSA Performance, has been misused, damaged by accident or negligence, altered or modified in any way, faulty installation or installed contrary to CORSA installation instructions, or repaired by an unauthorized service facility.

Full warranty available on www.corsaperformance.com

Please confirm that all parts are present according to the bill of materials before beginning the installation.

If something is missing call Tech Support at 440.891.0999 or Toll Free: 1.800.486.0999

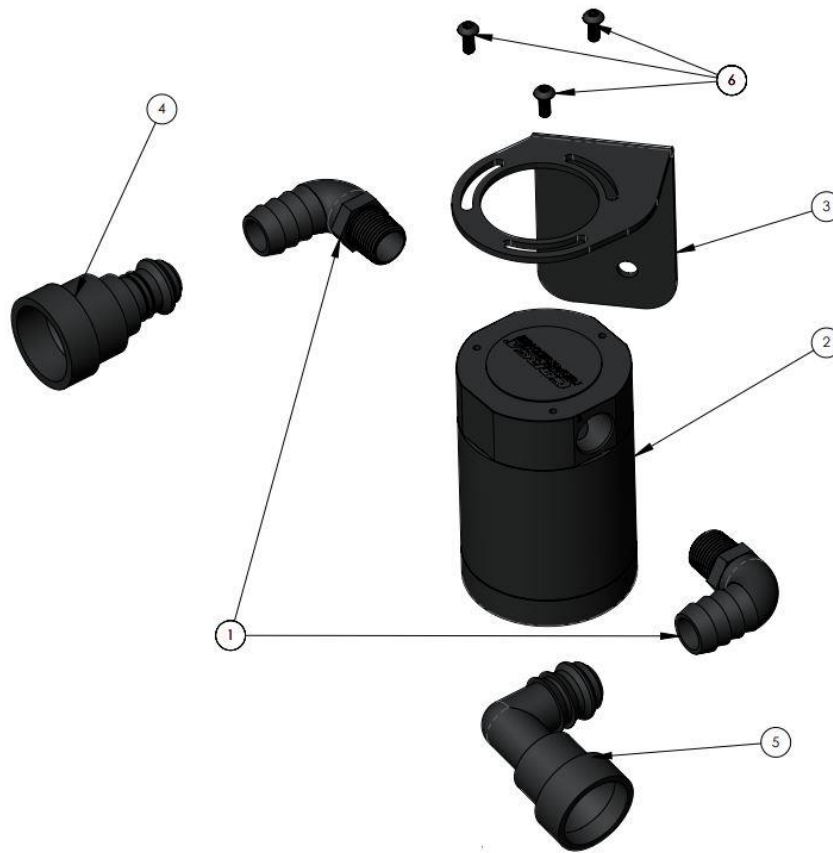

HARDWARE KIT

1. 3/8" NPT Elbow Fitting	2	3. Bracket	1	6. 4mm Hex Screws	3
2. Catch Can Body	1	4. 5/8" Straight Quick Disconnect Fitting	1	NOT PICTURED:	
		5. 5/8" Elbow Quick Disconnect Fitting	1	7. 5/8" Hose A	5.5"
				8. 5/8" Hose B	15.5"

REMOVAL INSTRUCTIONS

FACTORY
PCV LINE

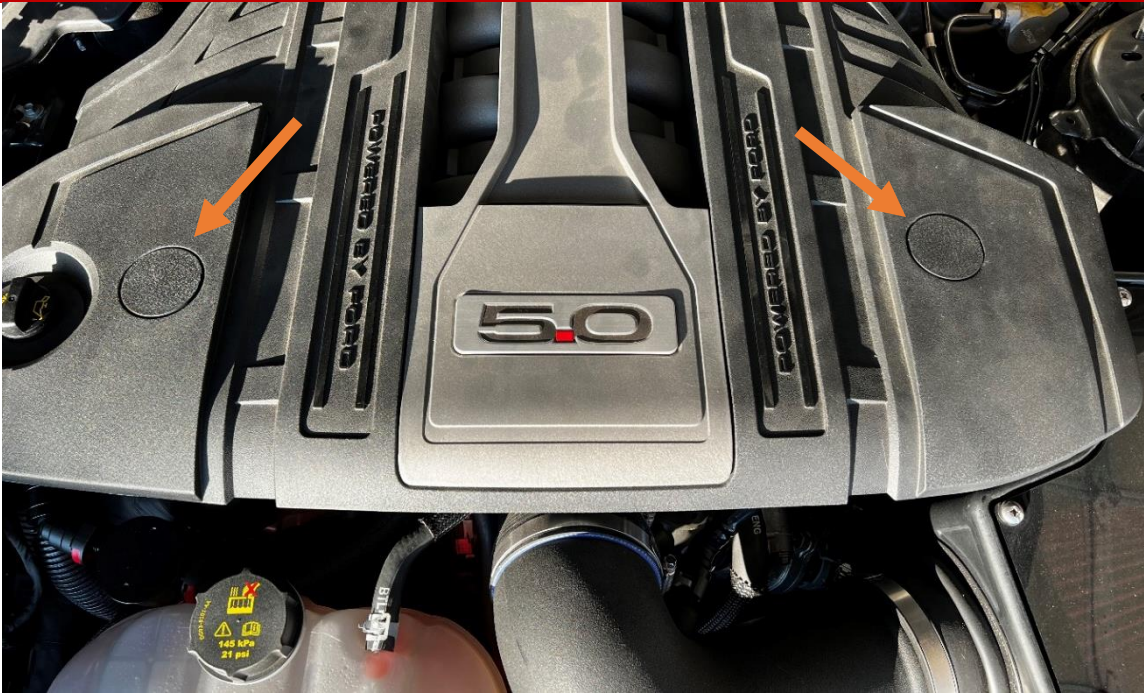

1. Remove engine cover by using a flathead screwdriver to remove the caps, revealing the bolt and nuts. Use a 10mm wrench to remove the nuts. Once nuts are removed, pull the engine cover off the 4 mounting points to remove the cover from the vehicle.



2. Remove stock PCV Line from vehicle by pulling on the tab on the 2 quick disconnect fittings.

This concludes removal instructions.

INSTALLATION INSTRUCTIONS

CORSA CATCH CAN SYSTEM



1. Use an 8mm Wrench to remove the bolt located next to the passenger side shock tower. Insert the Catch Can bracket and reinstall the 8mm bolt to secure bracket.
2. Insert barbed elbow fittings into the catch can. **IMPORTANT:** Corsa recommends using thread sealant or PTFE tape on barbed fittings and bottom drain plug to prevent any leaks.

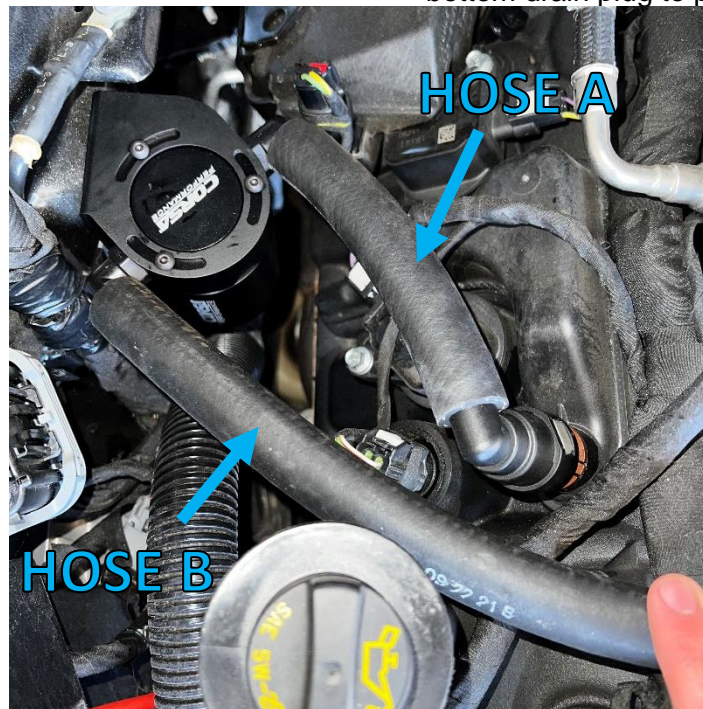

3. Install the catch can on to the bracket the 4mm Hex Screws and the 2.5mm Allen Wrench. Attach Hose A to the "A" side of the catch can and route it to the fitting closest to the catch can. Attach Hose B to the "B" side of the catch can and route to the fitting located further from the catch can.

This concludes installation instructions.

*Check that this catch can complies with your Federal, State and Local laws.
We recommend saving your stock PCV line.*

BEFORE ROAD TESTING

- 1.** Start engine, leaving the transmission in park and securing the parking brake.
 - 2.** Make sure to look and listen for any unusual noises or air leaks. Repair problems if needed.
 - 3.** Once completed it will be necessary to check periodically, after a few heat cycles, for realignment and tightening of all connections.
-

EMPTYING CATCH CAN: Twist off the bottom of the catch can and dispose of collected oil. It is recommended to check and empty the catch can with every oil change.