



Installation Instructions – JMS PedalMAX Kit P/N PX1114F 2011-2018 Ford Drive-By-Wire Electronic Throttle Enhancement Device

Included in the PedalMAX kit:

- (1) PedalMAX assembly
- (1) 4-pin RED de-sensitizing throttle plug
- (4) Cable ties

Please read the complete installation instructions before attempting to install this product. PedalMAX will increase the torque and responsiveness of the OEM drive-by-wire throttle assembly. The PedalMAX unit is designed to be mounted inside the vehicle cabin, under the dash near the accelerator pedal position sensor. PedalMAX should not come into direct or prolonged contact with water or extreme engine heat (+250F).



Connect the Assembly: Attach the black PedalMAX device to the wiring harness. Apply the supplied dielectric grease on the connector pins and plug the device into the 26-pin connector firmly until latched.



Important: Disconnect the positive terminal of the battery before installing this product. If you do not disconnect the battery the factory computer will not learn the correct starting pedal position.

Locate the pedal position sensor assembly. It is located on the top of the accelerator pedal.

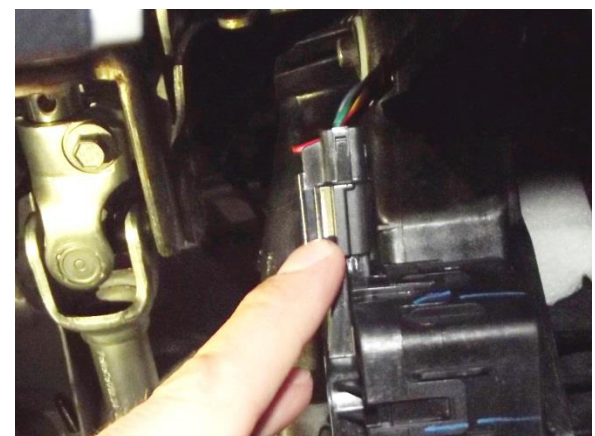

Unplug the wiring harness from the pedal position sensor.

Note: To separate the connector from the sensor: slide back the red locking tab on the harness connector and then press the black tab down to remove the connector.

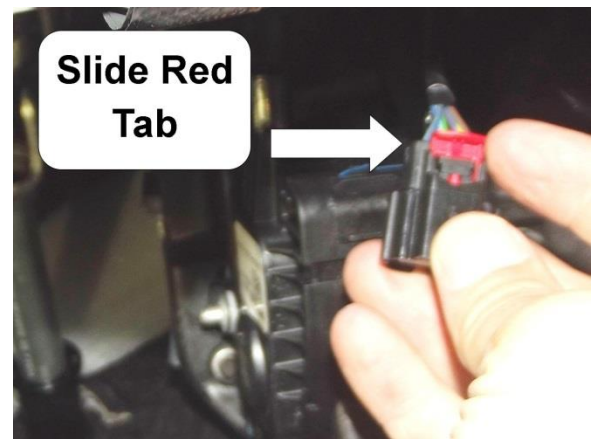

Plug the PedalMAX device in-line between the pedal position sensor and OE wiring harness by connecting the male and female PedalMAX connectors to the Original Factory connector and sensor.



Secure the PedalMAX unit using the supplied cable ties. The device should not be hanging loosely or unsecured. Do not attach or mount to any moving assemblies such as the steering column.

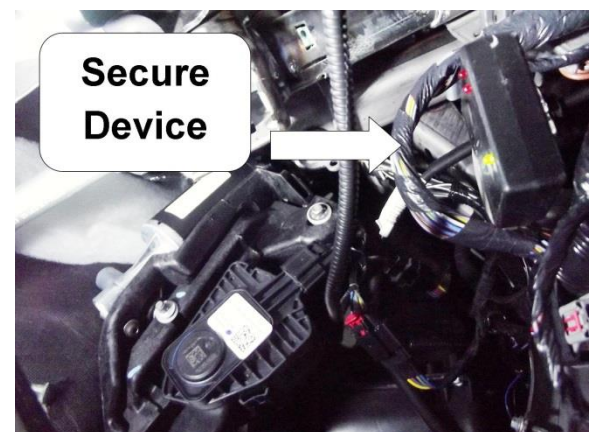

Optional 12-volt input feature: Many PedalMAX and all BoostMAX main harnesses now include a 12-volt input. This allows for consistent power to the device, and is required on many newer control systems (i.e. Ford vehicles and others). To use this feature, simply plug the weather-pack connector on the main harness, into the 12-volt input harness connector.

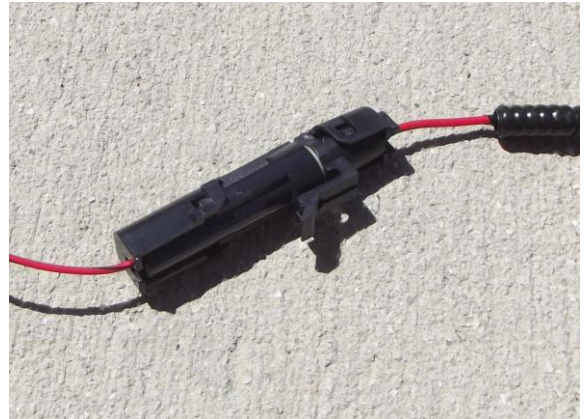

Connect the ring terminal on the 12-volt input harness directly to the positive side battery cable and fasten the cable terminal nut securely. You can also attach the 12-volt ring terminal to another 12-volt source such as the main power supply going into the fuse box.

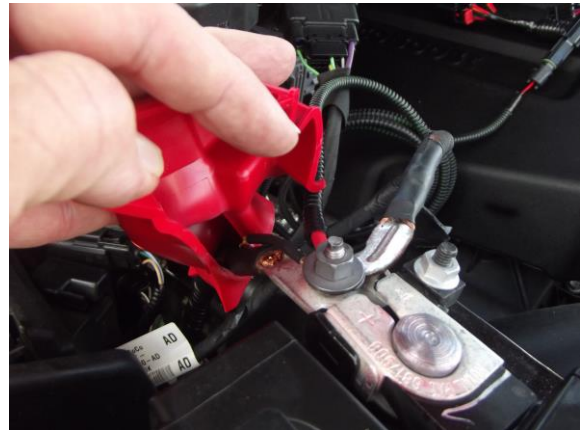

Test the device – Once the device is installed and secured, insert the ignition key, and start the vehicle. If you're using the 12-volt input, look at the device to make sure the green LED is illuminated, which alerts you that the device is active and functioning. If the device is not connected to 12-volt, there will be no LED illuminated.

Test drive the vehicle – Drive the vehicle under normal conditions. You should notice a significant improvement in throttle responsiveness and acceleration.

RED Plug: The PedalMAX device is pre-configured to provide the maximum increase in throttle response. If this amount of increase is too aggressive for your driving style, you can connect the supplied 4-pin RED de-sensitizing plug into the 4-pin connector on the device. The RED de-sensitizing plug will decrease the amount of increased throttle response to about 60% of the maximum setting for a less-aggressive response.

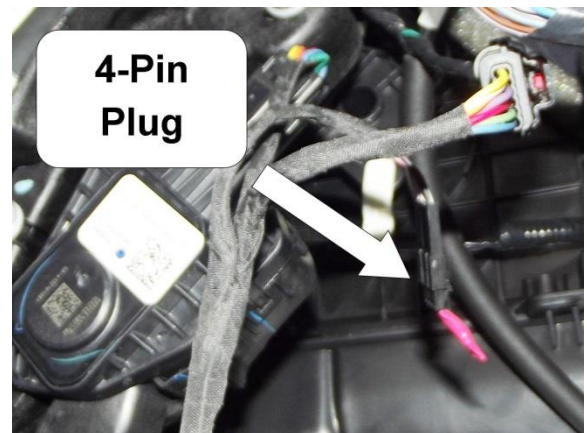

Notes and Troubleshooting:

- Check Engine Light - If you experience a check engine light and have no pedal response after starting the vehicle immediately following installation, and the green LED is illuminated, turn the key back to the off position, remove the ignition key and restart the vehicle after waiting 45 seconds. If you have a key fob: make sure that the vehicle is off and that the dash lights are off for at least 45 seconds. When you restart the car this should eliminate the check engine light and restore the pedal response.
- Red Plug – The PedalMAX device is pre-configured to provide a increase in throttle response. If this amount of increase is too aggressive for your application, you can connect the optional RED PLUG to decrease the throttle response.

Optional Control Accessory: The optional single pedal knob (P/N BX-6999-SINGLE) is designed to plug in to the 4-pin connector and over-ride the pre-configured throttle response settings. With this option, you have ultimate control over the sensitivity with a range of 0% increase to the 100% maximum increase, based on the position of the control knob.



Using PedalMAX in-line with BoostMAX:

PedalMAX and BoostMAX have been pre-engineered to work together for additional performance enhancement on Ford Ecoboost engines. In this scenario, PedalMAX will be installed in-line between the BoostMAX device and the pedal position sensor. The installation process is the same as noted above, except the PedalMAX harness will connect to the BoostMAX output connector and the pedal position sensor. Using PedalMAX in conjunction with BoostMAX adds some low-end horsepower and torque, along with the increase in throttle responsiveness.





PX1114F Supports the Following Vehicles:

- 2011-2018 Ford F-150
- 2011-2018 Ford F-250
- 2011-2018 Ford F-350
- 2011-2018 Ford F-450
- 2011-2018 Ford F-550
- 2011-2018 Ford Mustang
- 2011-2018 Ford Focus
- 2011-2018 Ford Fusion
- 2011-2018 Ford Taurus
- 2011-2018 Ford Edge
- 2011-2018 Ford Escape
- 2012-2018 Ford Flex
- 2011-2018 Ford Explorer
- 2011-2018 Ford Expedition
- 2012-2018 Ford C-Max
- 2012-2018 Ford B-Max
- 2010-2018 Ford S-Max
- 2011-2018 Ford Transit Connect
- 2011-2018 Ford Transit 150
- 2011-2018 Ford Transit 250
- 2011-2018 Ford Transit 350
- 2011-2018 Ford Transit 350 HD
- 2014-2018 Police Interceptor Utility
- 2013-2018 Police Interceptor Sedan
- 2011-2018 Ford Ranger T6 (Export)
- 2016-2018 Lincoln MKC
- 2011-2018 Lincoln MKX
- 2013-2018 Lincoln MKZ
- 2011-2018 Lincoln MKS
- 2011-2018 Lincoln MKT
- 2011-2018 Lincoln Navigator