



ORACLE LIGHTING

FOXBODY LX TAILLIGHT KIT
ORACLE PART # 8208-023
DIY INSTALLATION GUIDE

TOOLS NEEDED:
11mm Socket Wrench
Dremel+ Cutting Wheel
Drill with 1/16 Drill Bit

STEP: 1

WATCH THE VIDEO

SCAN QR OR VISIT:



[YOUTU.BE/-NUOSYCOSCK](https://youtu.be/-NUOSYCOSCK)

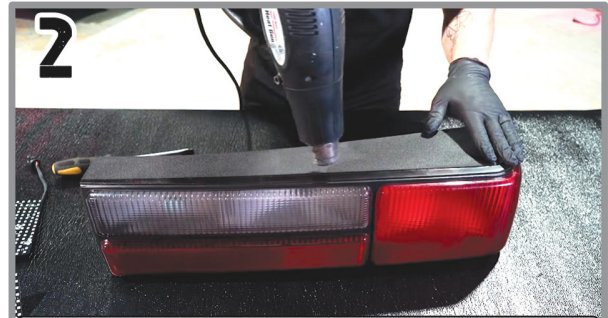

2
USING A HEATGUN WARM THE HEADLIGHT BUTYL SEAL UNTIL TACKY AND THE GENTLY PRY APART THE LENS.



3
REMOVE THIS PLASTIC FIN FROM THE INNER HOUSING USING DREMEL WITH CUTTING WHEEL- EYE PROTECTION

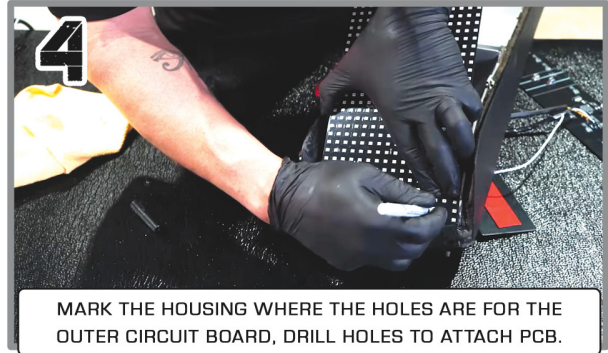

4
MARK THE HOUSING WHERE THE HOLES ARE FOR THE OUTER CIRCUIT BOARD, DRILL HOLES TO ATTACH PCB.

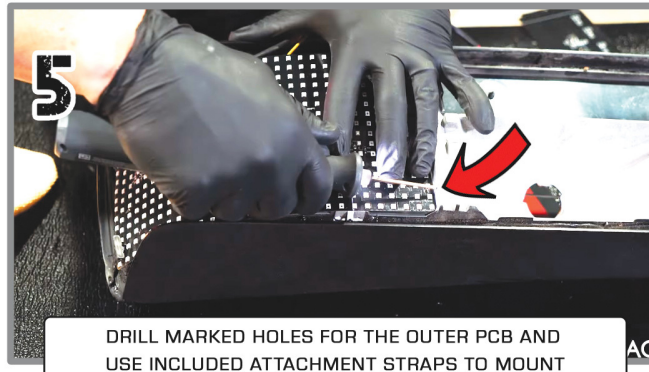

5
DRILL MARKED HOLES FOR THE OUTER PCB AND USE INCLUDED ATTACHMENT STRAPS TO MOUNT



6
REPEAT THESE STEPS FOR THE INNER UPPER AND THE INNER LOWER PCB COMPONENTS.

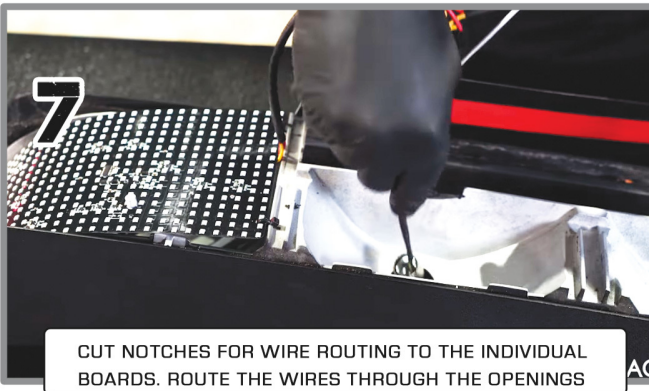

7
CUT NOTCHES FOR WIRE ROUTING TO THE INDIVIDUAL BOARDS. ROUTE THE WIRES THROUGH THE OPENINGS

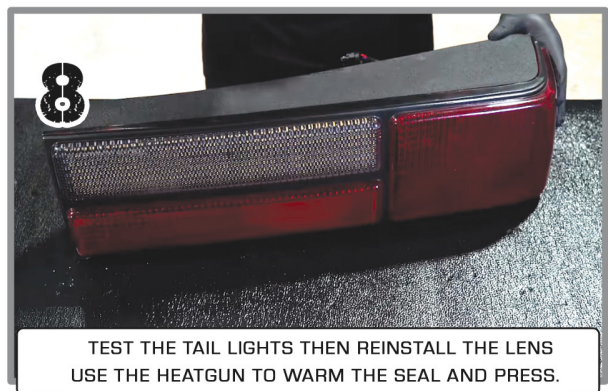

8
TEST THE TAIL LIGHTS THEN REINSTALL THE LENS USE THE HEATGUN TO WARM THE SEAL AND PRESS.



www.oraclelights.com

© 2026 ORACLE LIGHTING

4401 Division St.
Metairie, LA 70002

FOR ADDITIONAL TECHNICAL SUPPORT PLEASE CALL US 1(800)407-5776