

Step 1. Housing Trim Removal:

1. Open Trunk.
2. Remove the four Center Pin Lock Retainers securing the plastic trim panel at latch by lifting the head of the center portion then remove retainer from panel. Remove the two Torx Head Plastic Screws from the upper area of trim panel, one per side, directly behind each taillight in trunk. Remove trim panel, it is not necessary to remove the Shaker 1000 stereo Subwoofers to remove this trim panel.

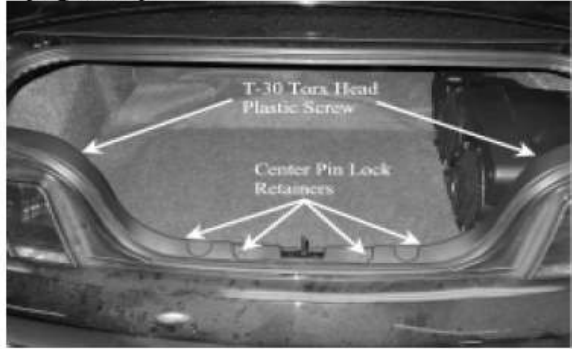

3. Remove 11mm nuts securing taillight housing to the vehicle, 3 per taillight housing.

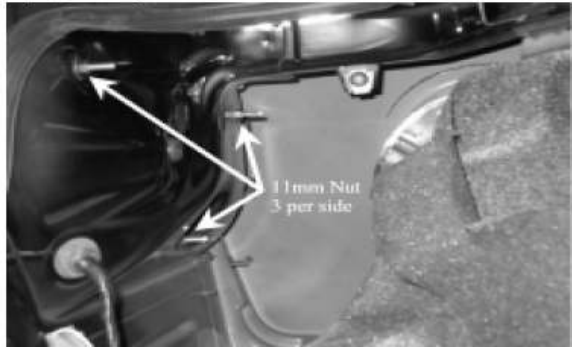

It is not necessary to remove the housing from the car or to disconnect the wire harness. The housing is shown here removed from the car for clarity only.

Make sure the lights are turned off and the ignition is off before you proceed further. Remove all of the turn/driving lamps from each housing (6 lamps total).

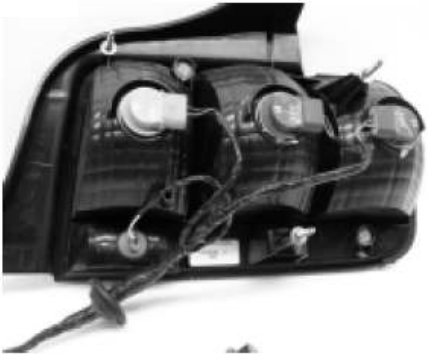

Note: The Sequential assemblies are interchangeable; there is no left or right side.

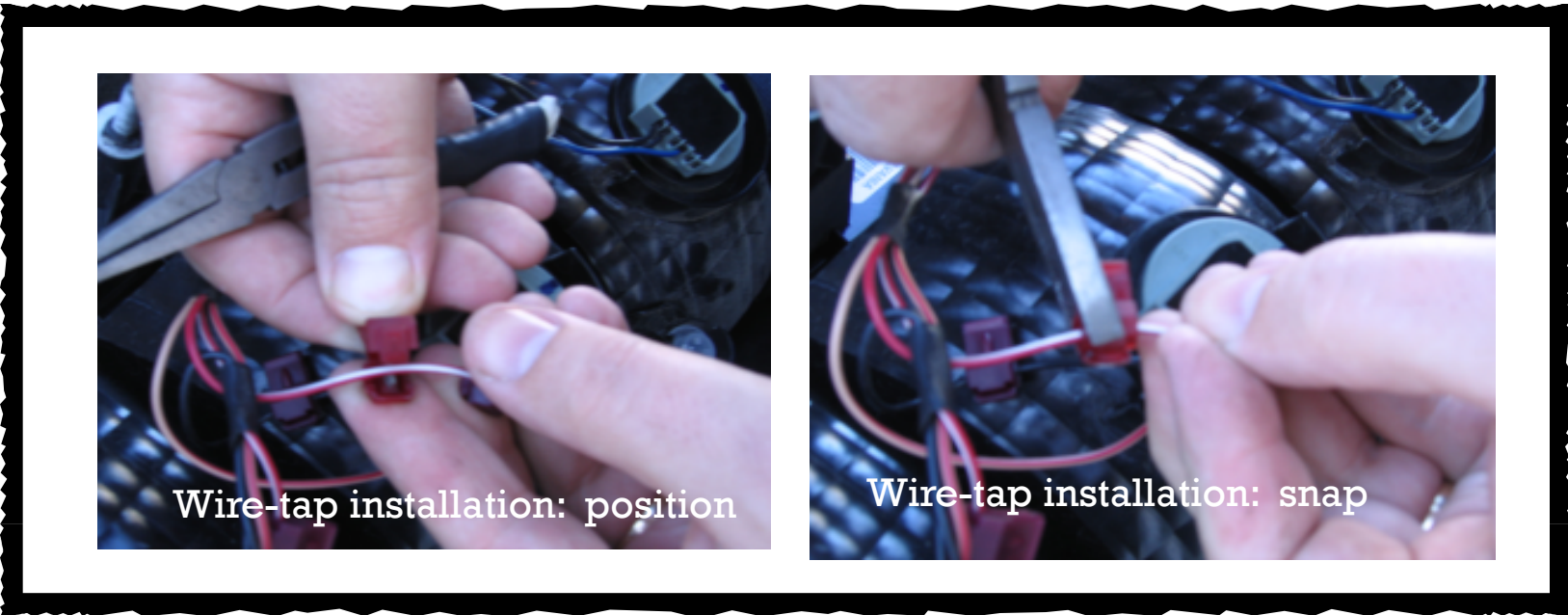

Step 2 Attach wire tap connectors:

Start by attaching 3 wire tap connector per car side. It is not necessary to remove the harness from the car or to modify the harness by cutting it in any way.

Apply connectors on each side as follows:

On the RIGHT side of the car:

- Apply 3 (**three**) wire tap connectors on the Orange/Blue or Grey - stripe wire which exits the **AMBER** lamp socket — this will be the orange with blue stripe wire which exits the socket near the **edge** of the socket(see white arrow). Do not attach the wire tap connectors to the black wire exiting the socket.



On the LEFT side of the car:

- Apply 3 (**three**) wire tap connectors on the Green/Orange -stripe wire which exits the **AMBER** lamp socket — this will be the green with orange stripe wire which exits the socket near the **edge** of the socket(see white arrow). Do not attach the wire tap connectors to the black wire exiting the socket.

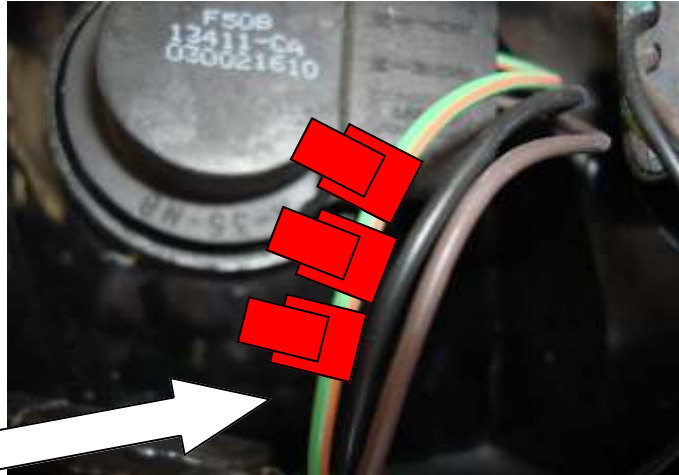

Step 3. Make Connections:

Insert the LED modules:

1. Install the inner most LED module first. **The LED modules are inserted into the socket so that the silver mark faces towards the wires from the socket.** Insert the module as shown. Be careful to allow the small diameter RED wire to exit the housing under the rubber washer so that it is *not cut or broken by one of the locking tabs on the inner socket.*
2. Install the middle LED module. **The LED modules are inserted into the socket so that the silver mark faces towards the wires from the socket.**
3. Install the **outer** LED module. **The LED modules are inserted into the socket so that the silver mark faces towards the wires from the socket.**
4. Insert ends of RED wires exiting from each socket to wire tap connectors **as shown below.**

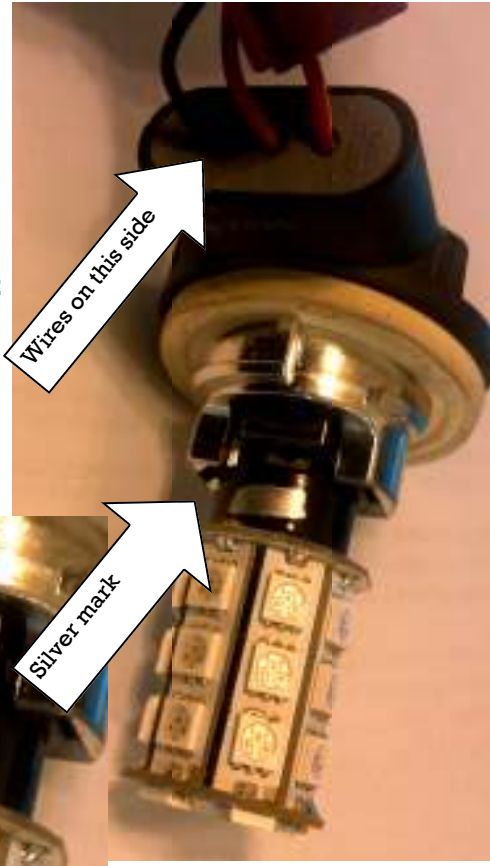

NOTE: If a lamp does not light it may be reversed double check to ensure they are oriented as above simply remove rotate 180 degrees and reinsert.

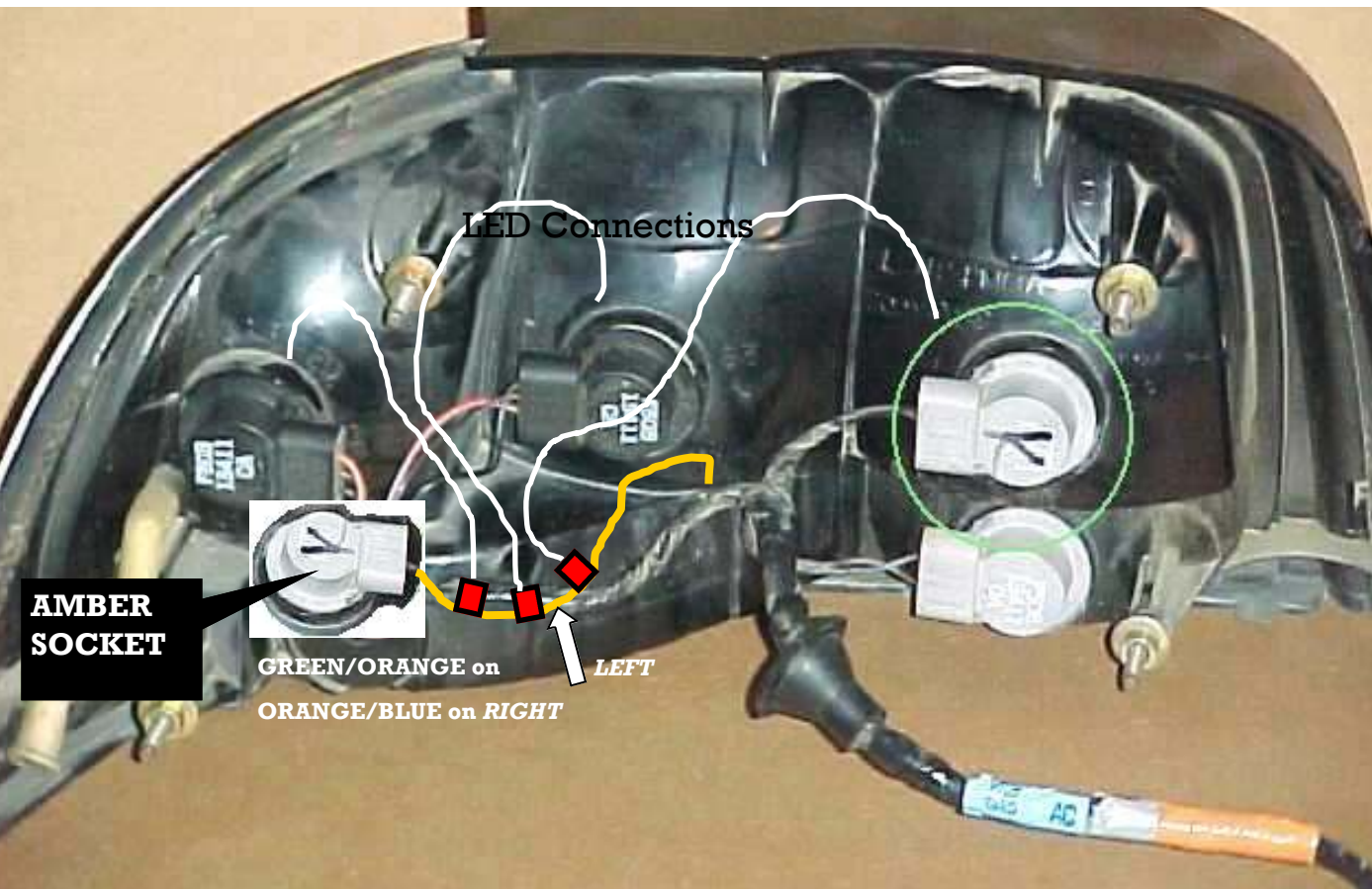

Step 4: Install Flasher:

The flasher is located on drivers side of the car next to hump under the dash. Unplug the OEM square 5 pin module and replace. Simply plug-in directly the new module pictured above. The plug cannot be plugged in wrong as it is polarized.

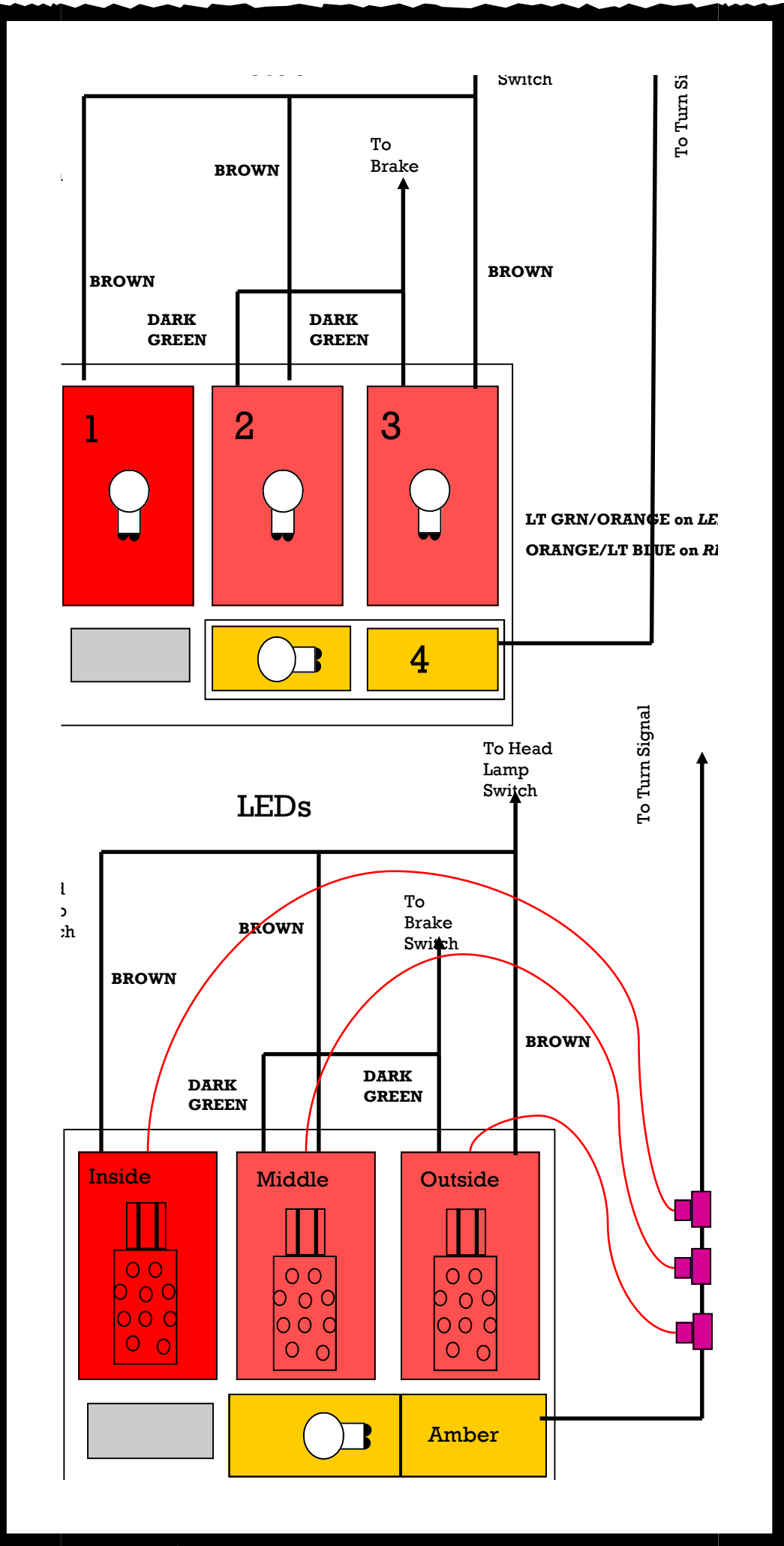

Reference wiring diagrams: